

RECENT FIELDWORK OF THE INTERNATIONAL ARCHAEOLOGICAL PROJECT AT ZALDAPA, BULGARIA

Albena Milanova (Sofijski universitet « Sv. Kliment Ohridski »)
Nicolas Beaudry (Université du Québec à Rimouski)
Georgi Atanasov (Regionalen istoricheski muzej- Silistra)
Dominic Moreau (Université de Lille / UMR 8164-HALMA)
Avec la collaboration de:
Brahim M'Barek, Eveha, France
Elio Hobdari, Instituti i arkeologjisë, Tirana, Albania

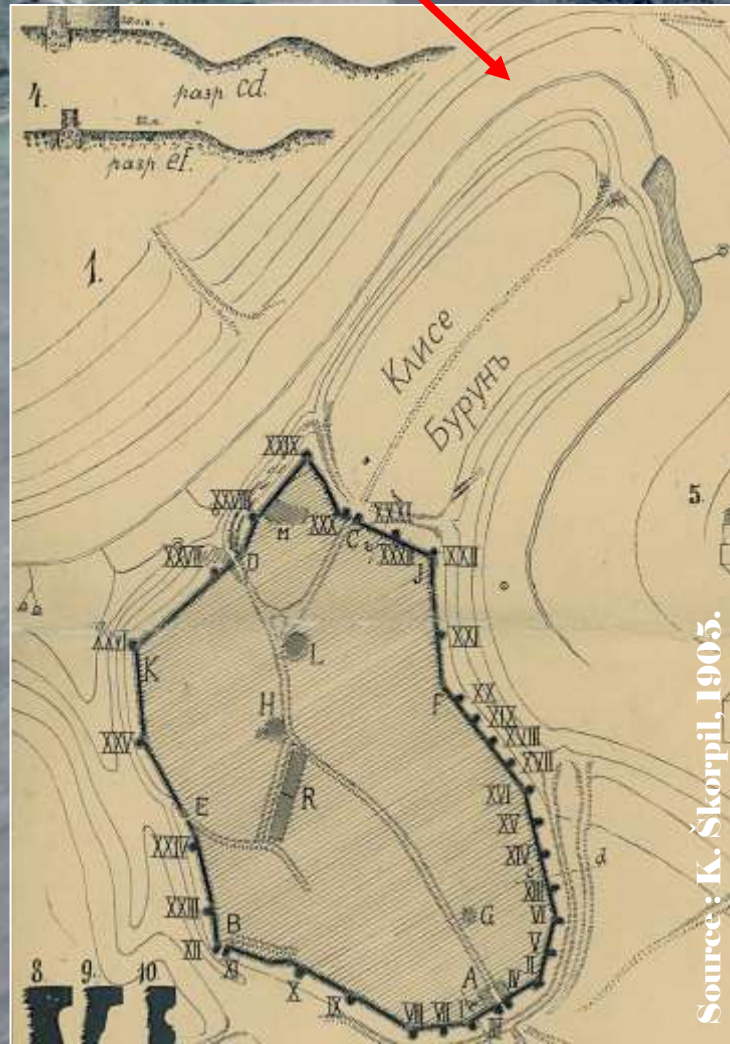


Zaldapa in the Written Sources (at courtesy of Dominic Moreau)

Hierocles, <i>Synekdemos</i>	Ζέλδεπα
Procopius of Caesarea, <i>De aedificis</i>	Ζάλδαπα
John of Antioch, <i>Fragmenta ex historia chronica</i> (from : Constantine Porphyrogenitus, <i>De insidiis</i>)	Ζάλδαβα
Theophylact Simocatta, <i>Historiae</i>	Ζάλδαπα (four occurrences)
<i>Notitia episcopatum Ecclesiae Constantinopolitanae 3</i> (in a list inspired by : Hierocles, <i>Synekdemos</i>)	Ζελδίπας
Theophanes Confessor, <i>Chronographia</i>	Ζάρδαπα (two occurrences)
Constantine Porphyrogenitus, <i>De thematibus</i> (in a list taken from : Hierocles, <i>Synekdemos</i>)	Ζέλπα

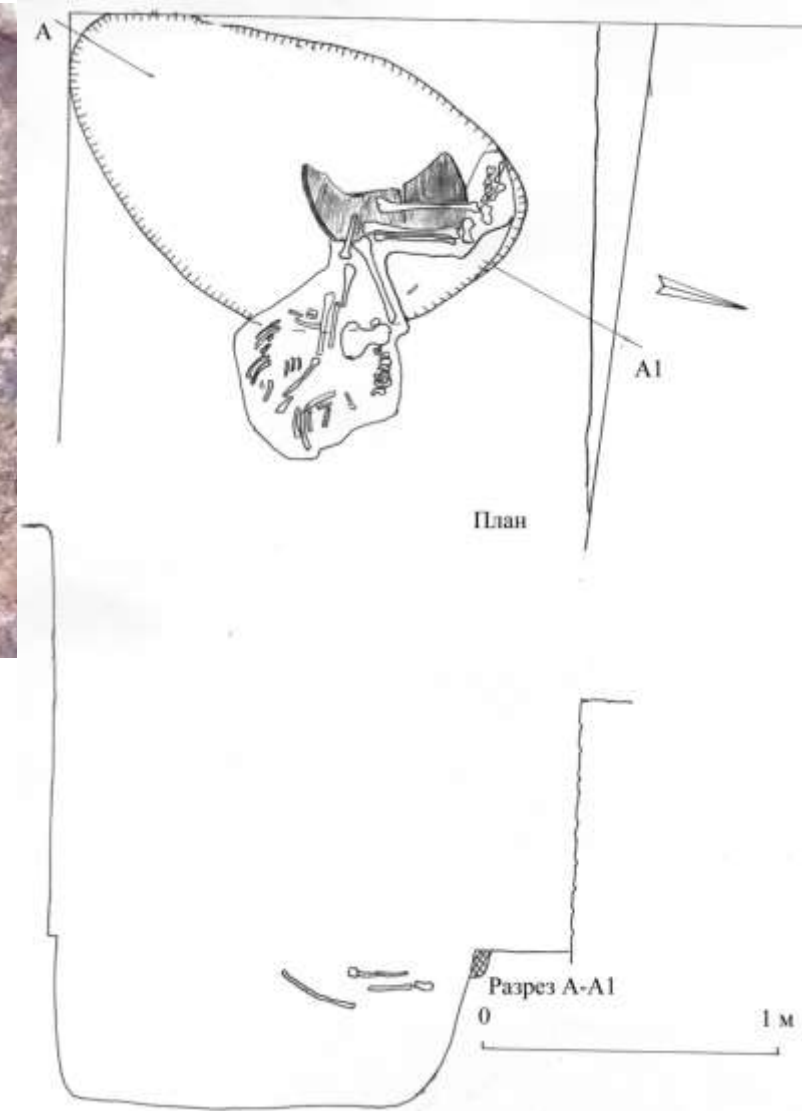
Ancien lit d'une rivière
(jusqu'en 1949)

Lac artificiel



Source: K. Škorpič, 1905.

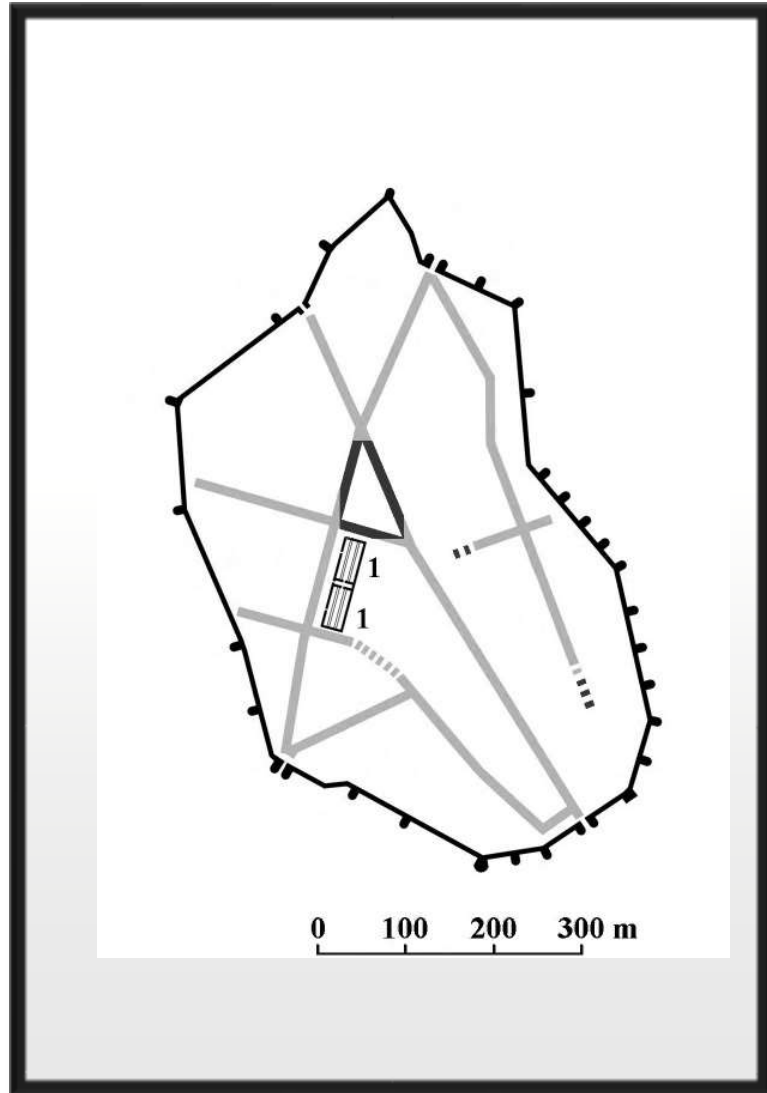
Early human occupation of the site - burials in foetal position skeletons and handmade table ware



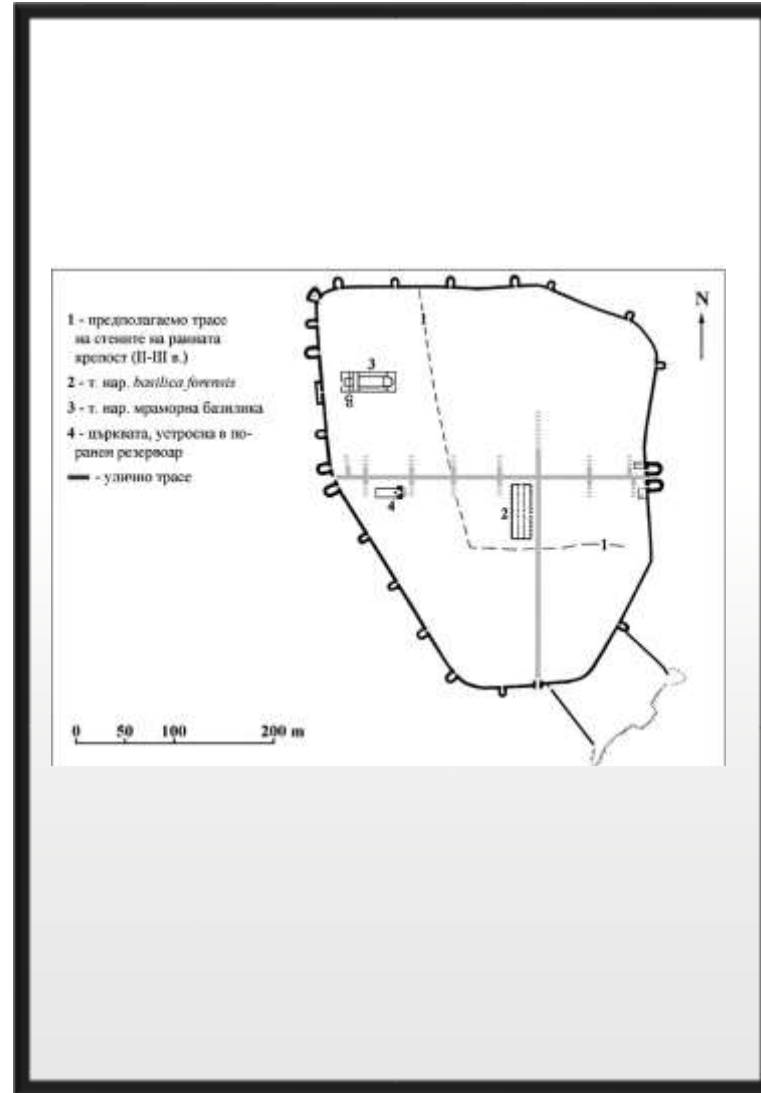


- The fortified site of Zaldapa was founded in the second quarter of the fourth century during the extensive campaign of fortifications *a fundamentis* in the province of Scythia Minor, which was little urbanized outside the coastal line. The military strengthening had begun towards the end of the third century after the Goths' invasions as a preventive measure against future Barbarian attacks. With its 25 ha intra-muros territory and at least two outside quarters Zaldapa is the biggest one in the hinterland of the Lower Danubian provinces.

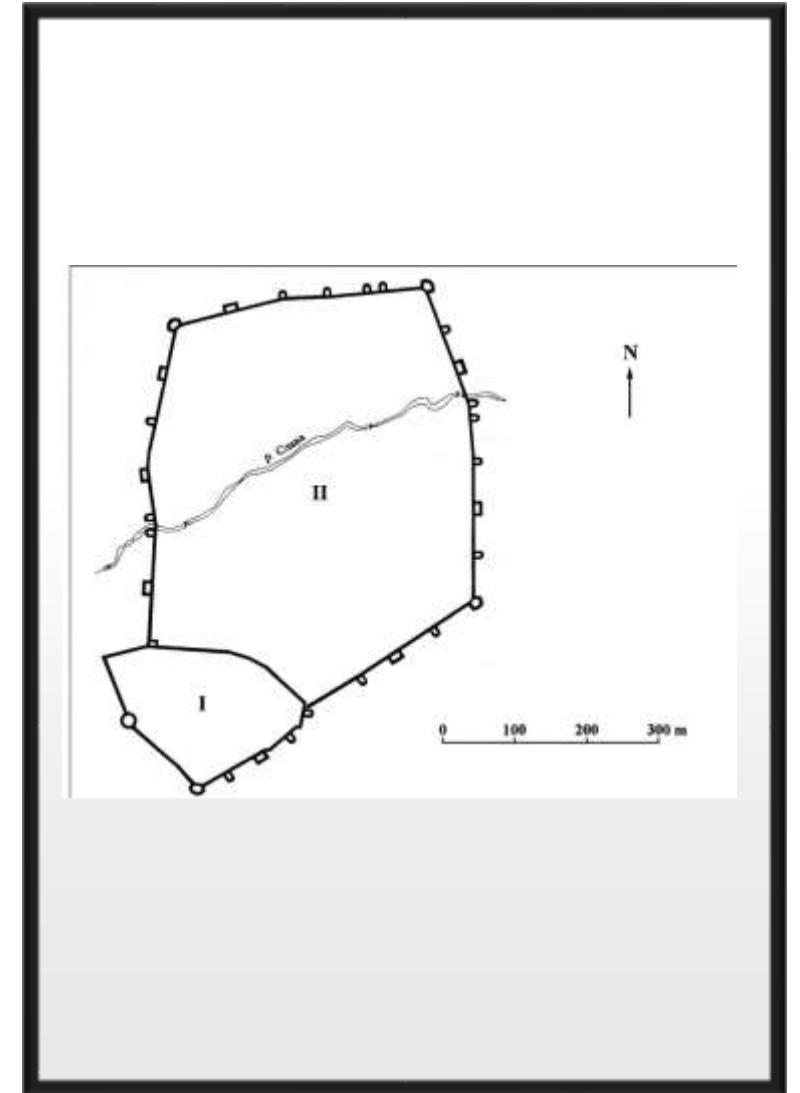
The new fortified sites in the inner zone of Scythia at the beginning of the 4th Century



Zaldapa (S.Torbatov)



Tropaeum Traiani (V. Dinchev based on Barnea and Suceveanu)



Ibida (V. Dinchev based on Scorpan 1980)

L'Empire romain au IV^e s.



Le diocèse de Thrace



La province de Scythie Mineure



L'agglomération de Zaldapa



Zone intra-muros

Quartiers extra-muros



Zaldapa: city plan according to excavations and DIDAR (made in 2021, I-SITE ULNE Foundation/DANUBIUS Project).



Zaldapa with its urban fabric in the regional urban and route system.

The Zaldapa International Project



The Zaldapa International Project

Georgi Atanasov (Regional Historical Museum of Silistra, Bulgaria)

Albena Milanova (Sofia University „St. Kliment Ohridski“, Bulgaria)

Nicolas Beaudry (University of Quebec at Rimouski, Canada)

Dominic Moreau (University of Lille, France)



The Zaldapa International Project

Georgi Atanasov (Regional Historical Museum of Silistra, Bulgaria)

Albena Milanova (Sofia University „St. Kliment Ohridski“, Bulgaria)

Nicolas Beaudry (University of Quebec at Rimouski, Canada)

Dominic Moreau (University of Lille, France)

Brahim M'Barek (Eveha, France)

Philip J. E. Mills (University of Leicester, UK)

Elio Hobdari (University of Tirana, Albania)

Ioto Valeriev (Regional Historical Museum of Burgas)

Slavi Kirov (University of Bordeaux)



The Zaldapa International Project

Georgi Atanasov (Regional Historical Museum of Silistra, Bulgaria)

Albena Milanova (Sofia University „St. Kliment Ohridski“, Bulgaria)

Nicolas Beaudry (University of Quebec at Rimouski, Canada)

Dominic Moreau (University of Lille, France)

Brahim M'Barek (Eveha, France)

Philip J. E. Mills (University of Leicester, UK)

Elio Hobdari (University of Tirana, Albania)

Ioto Valeriev (Regional Historical Museum of Burgas)

Slavi Kirov (University of Bordeaux)

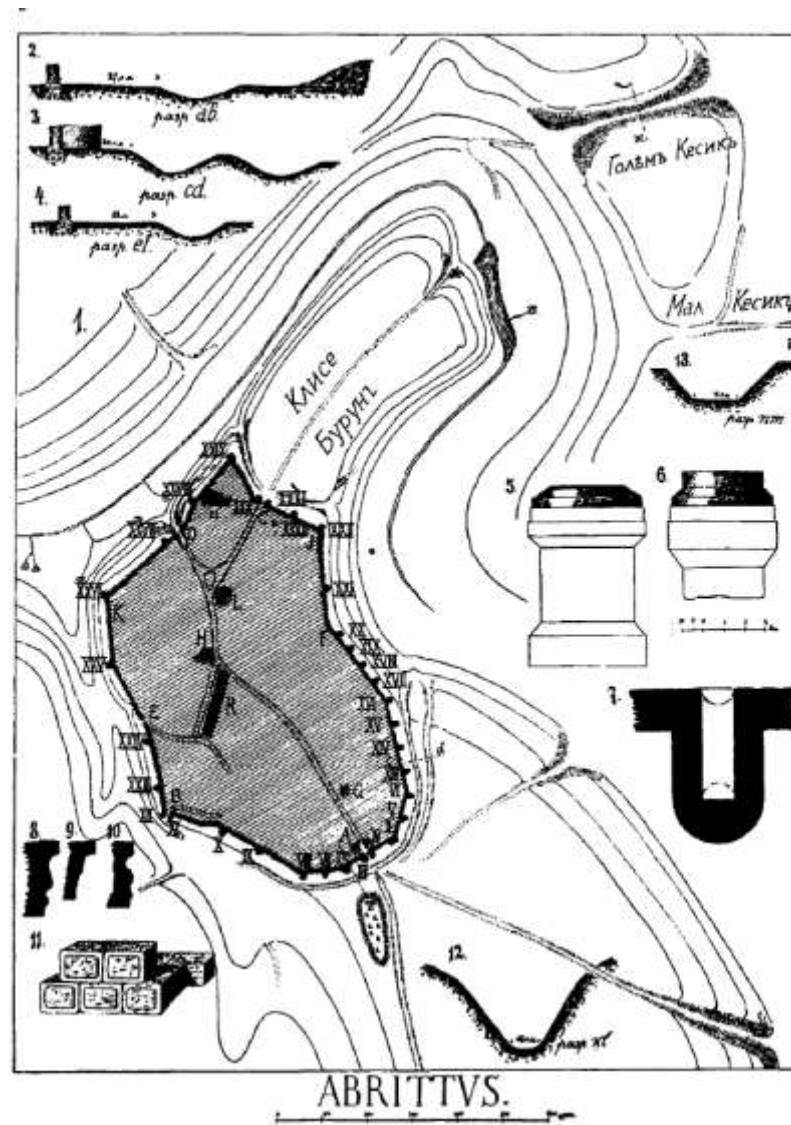


Alexander Ivanov, Ivan Gargano,
Jérémy Gribaut, Anthony Carnaux,
Lyobomir Malinov, David L. Tremblay
Priscilla Ralli

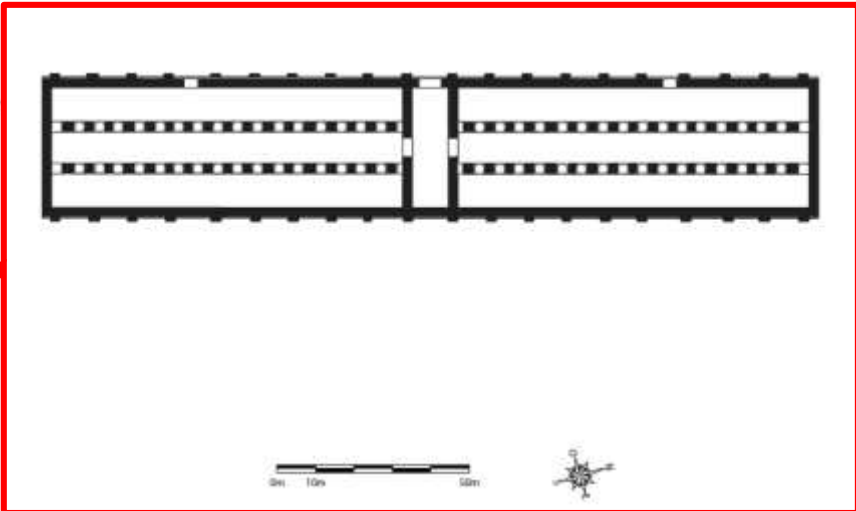
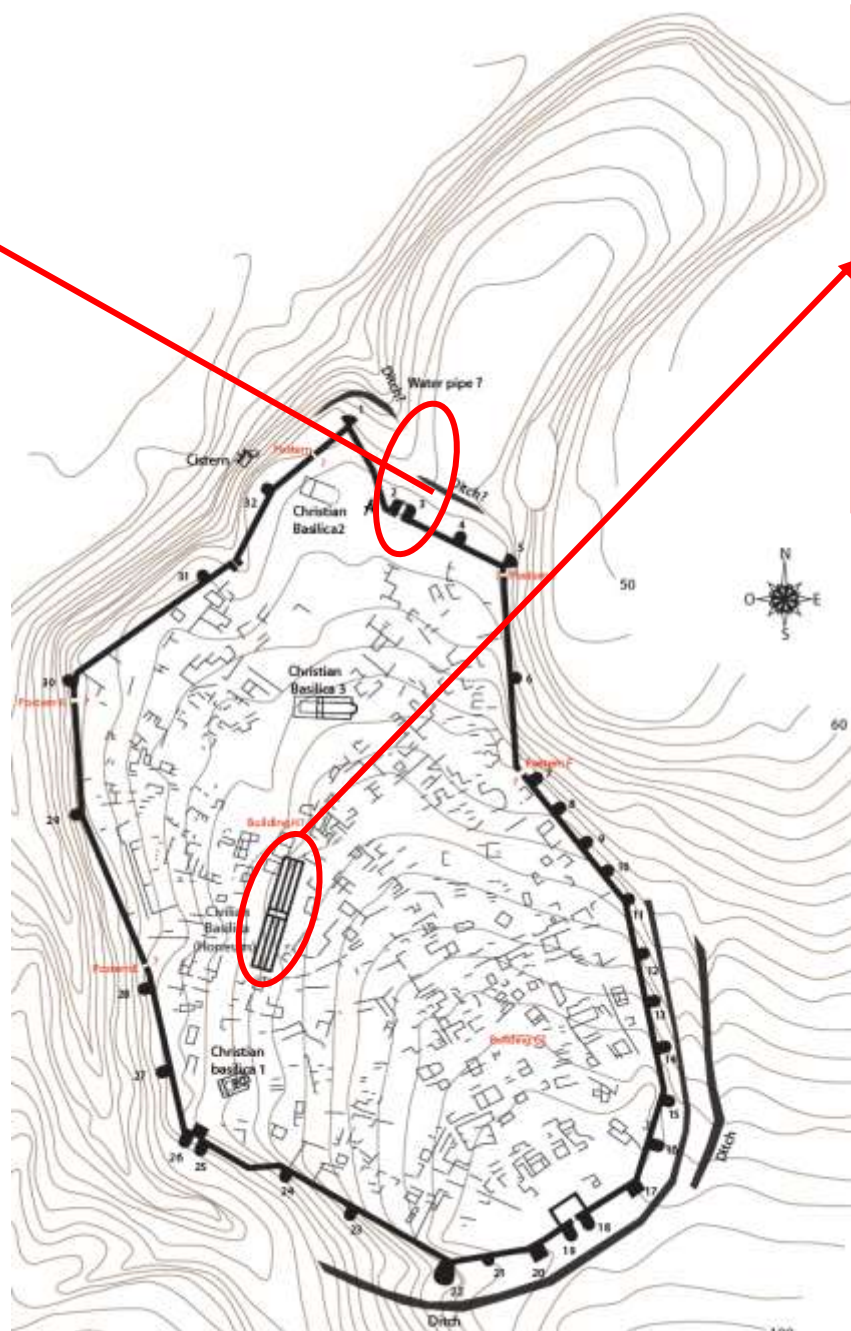
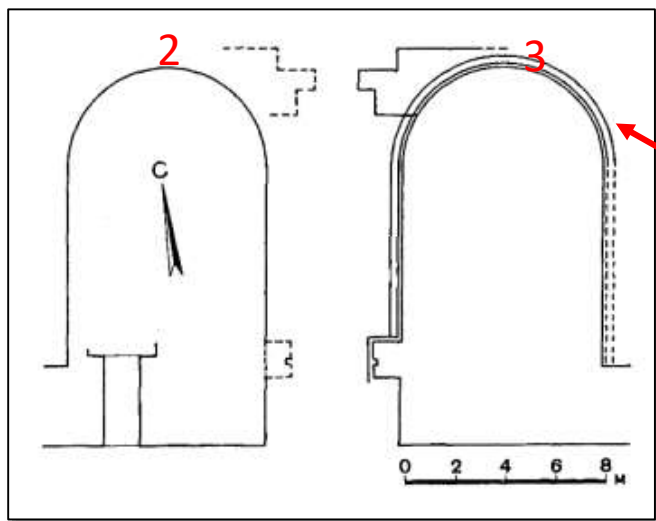
Skorpil's plans of the site



The very first one -1889

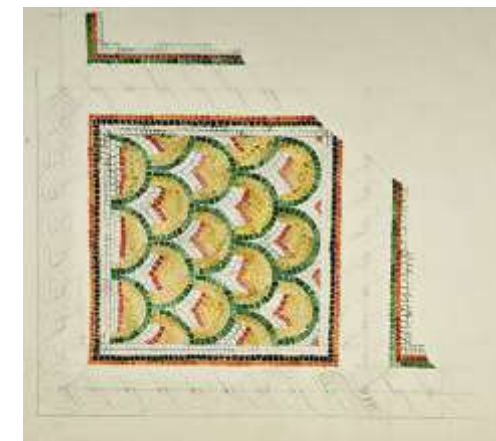
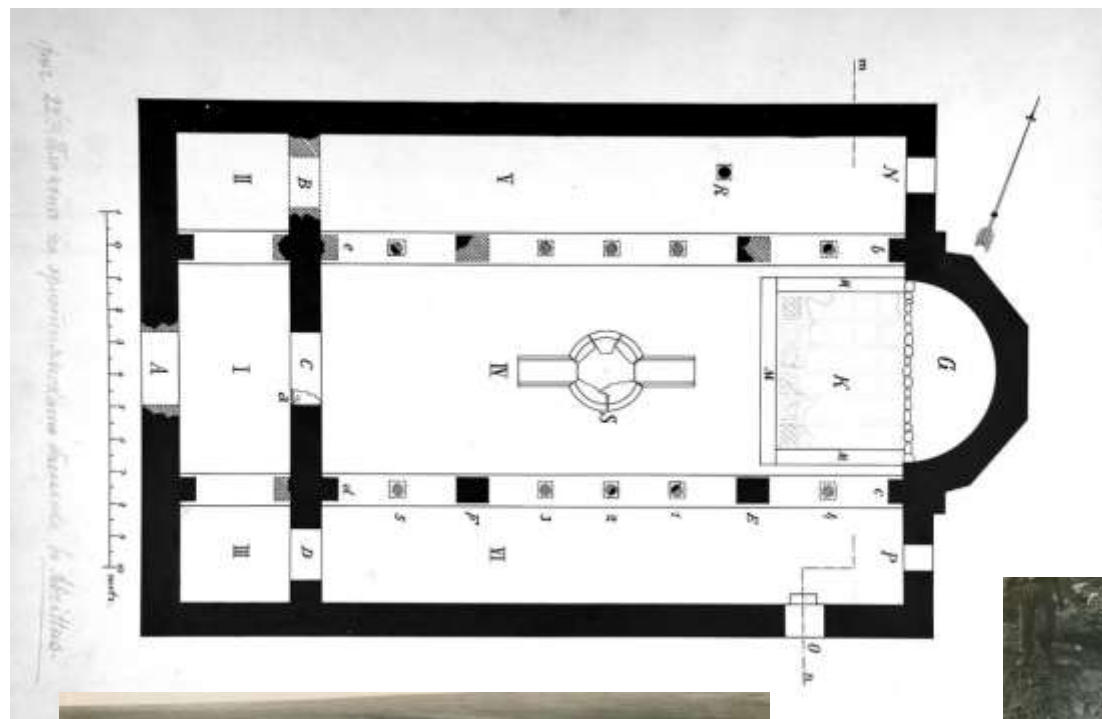
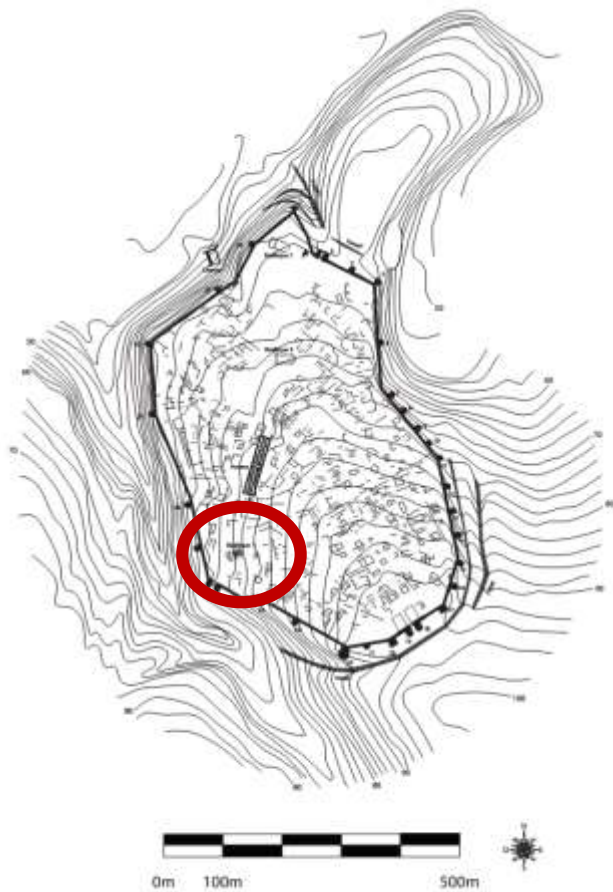


The Tour #3 of the Northern gate and the so-called "Civilian Basilica", which can be an *horreum*



Dimensions : 100 m X 18 m

Location of the basilica No 1 in Zaldapa.
Karel Škorpil research of the basilica – layout, the mosaic floor, sculpture

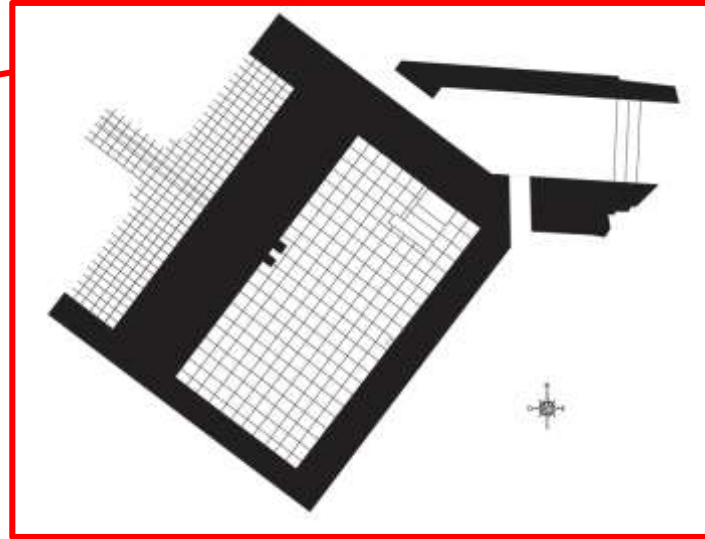
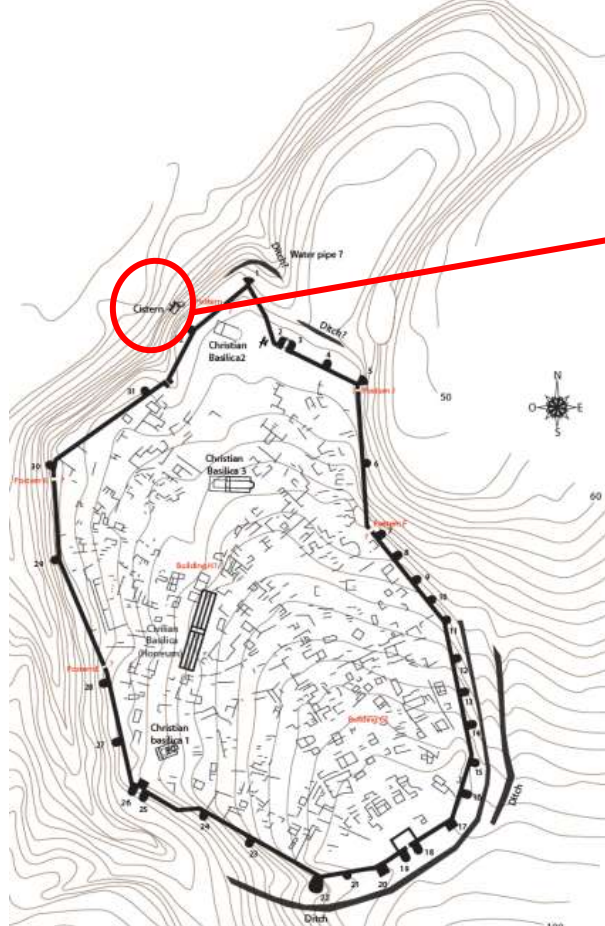


Mosaics in the bema



ambo

The Cistern

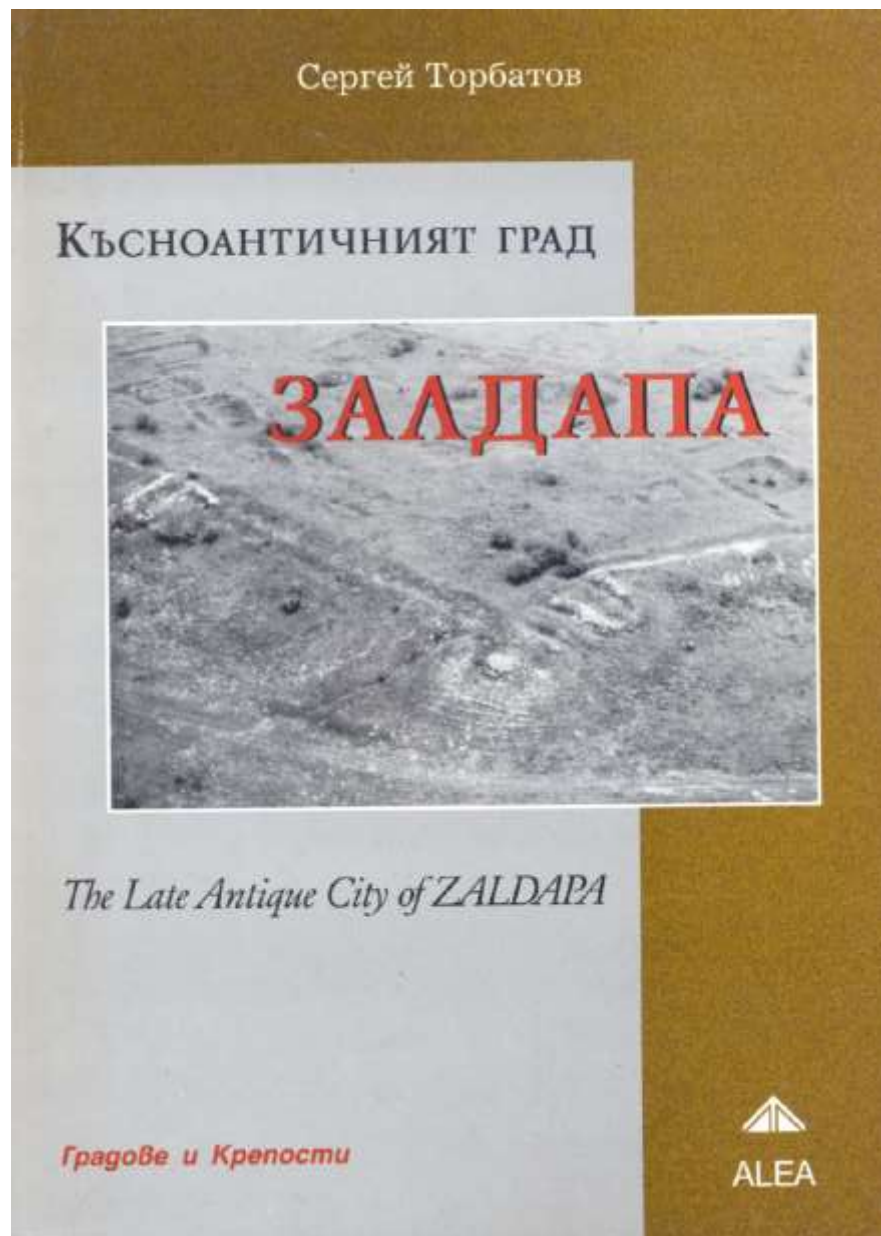


Found and excavated in 1949
by Milko Mirchev (published
in 1951)



New archaeological intervention in 2016 by the Regional Museu, in Dobric

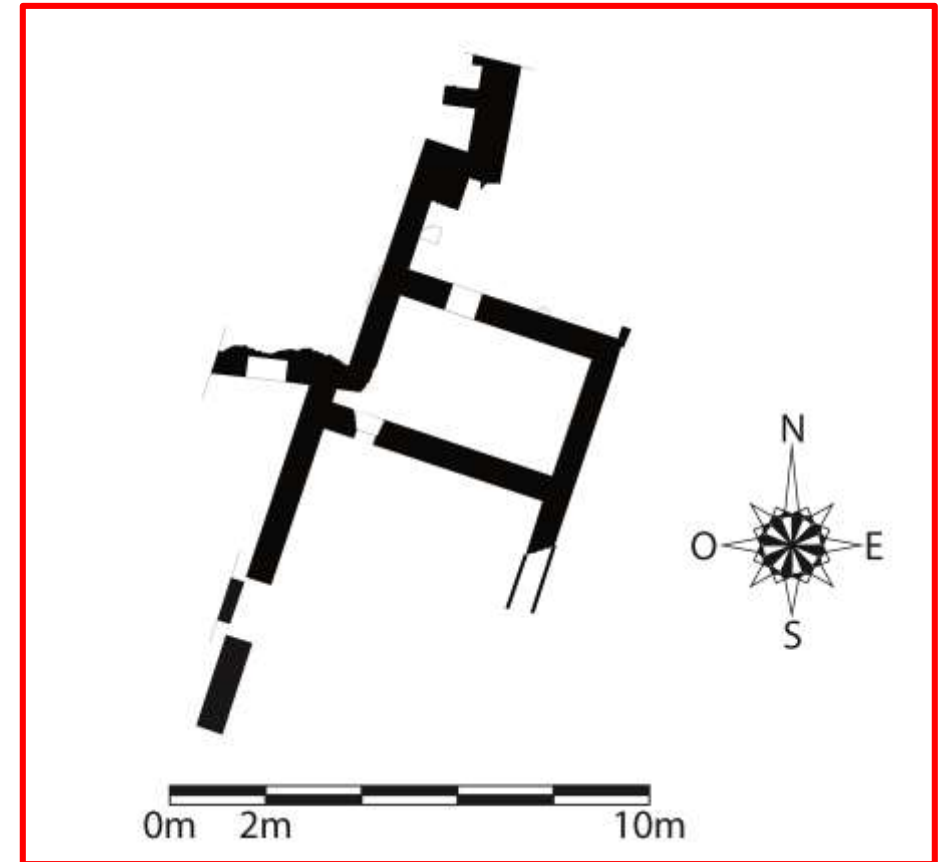
The most important book on Zaldapa was published in 2000 by Sergej Torbatov



Building 1, situated between the NE gate and the basilica n. 2

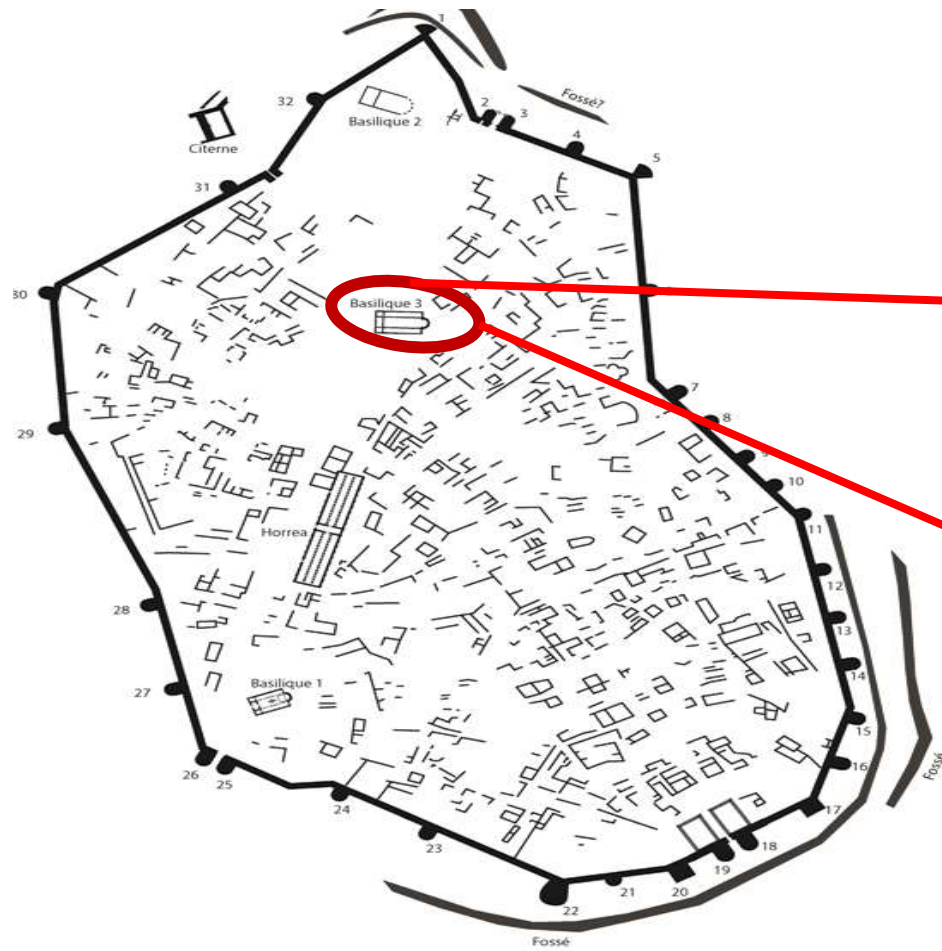


Photo: Ioto Iotov

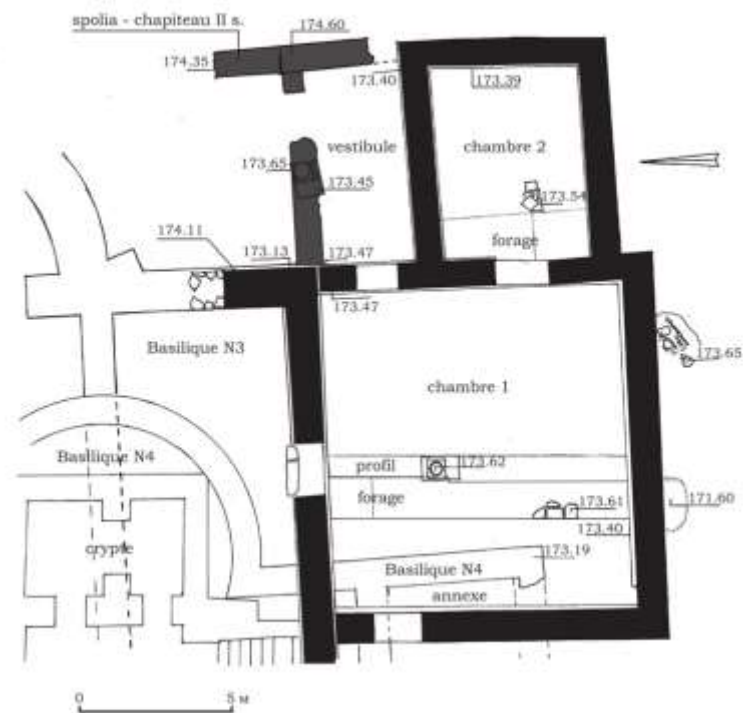
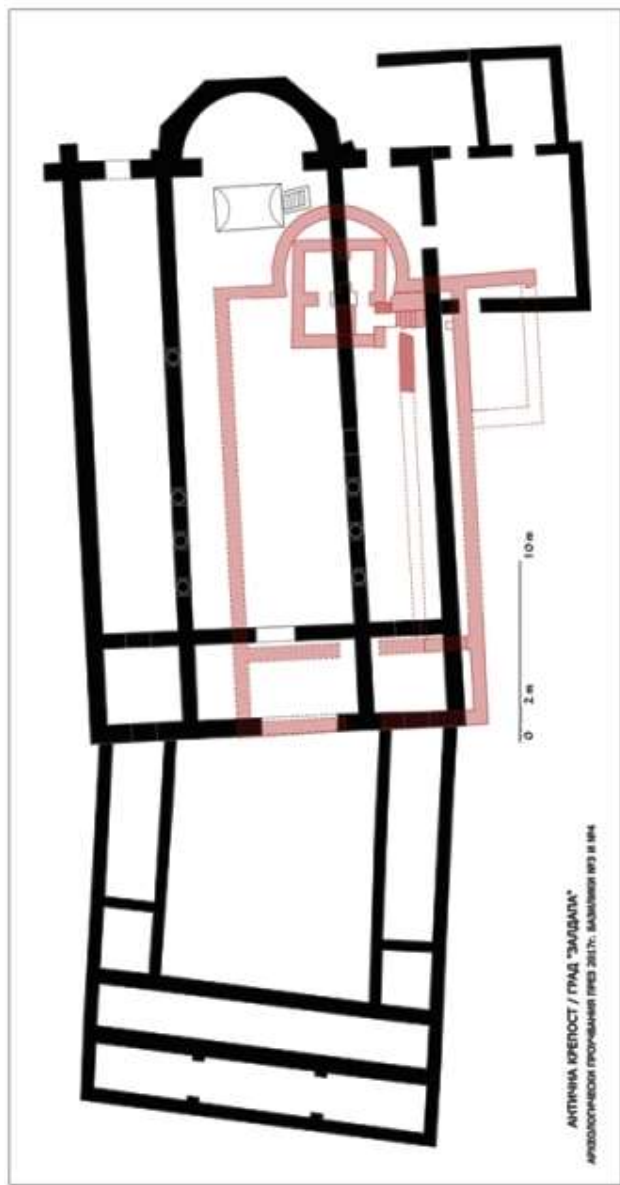


Partially excavated in 2014

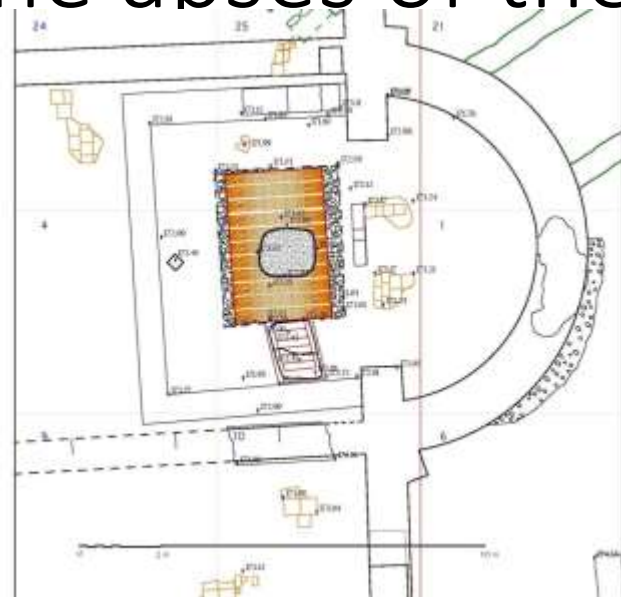
Basilica #3, situated approximatively at the cross-point of the two principal streets



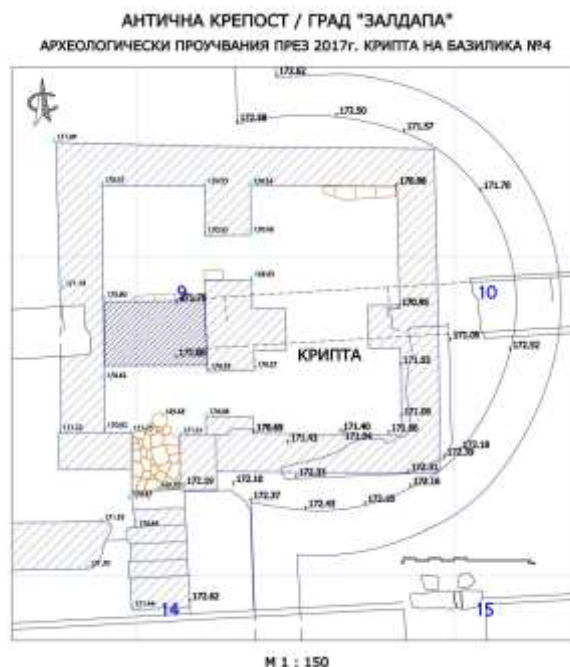
BASILICAS #3 and 4 with the Bishopric residence (?)



The crypts under the apses of the basilicas #3 and 4



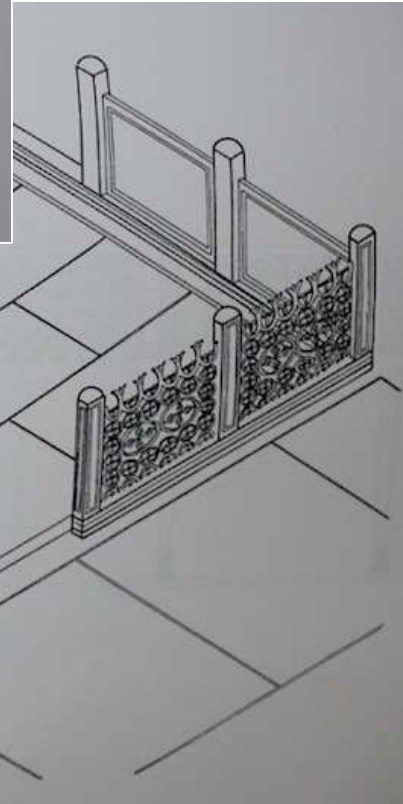
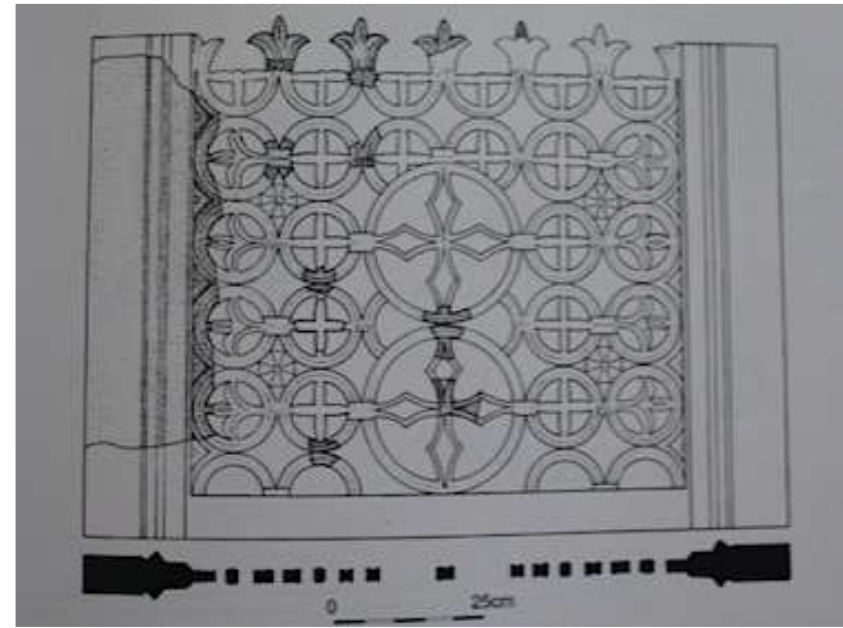
The crypt of the basilica 3



The crypt of the basilica 4

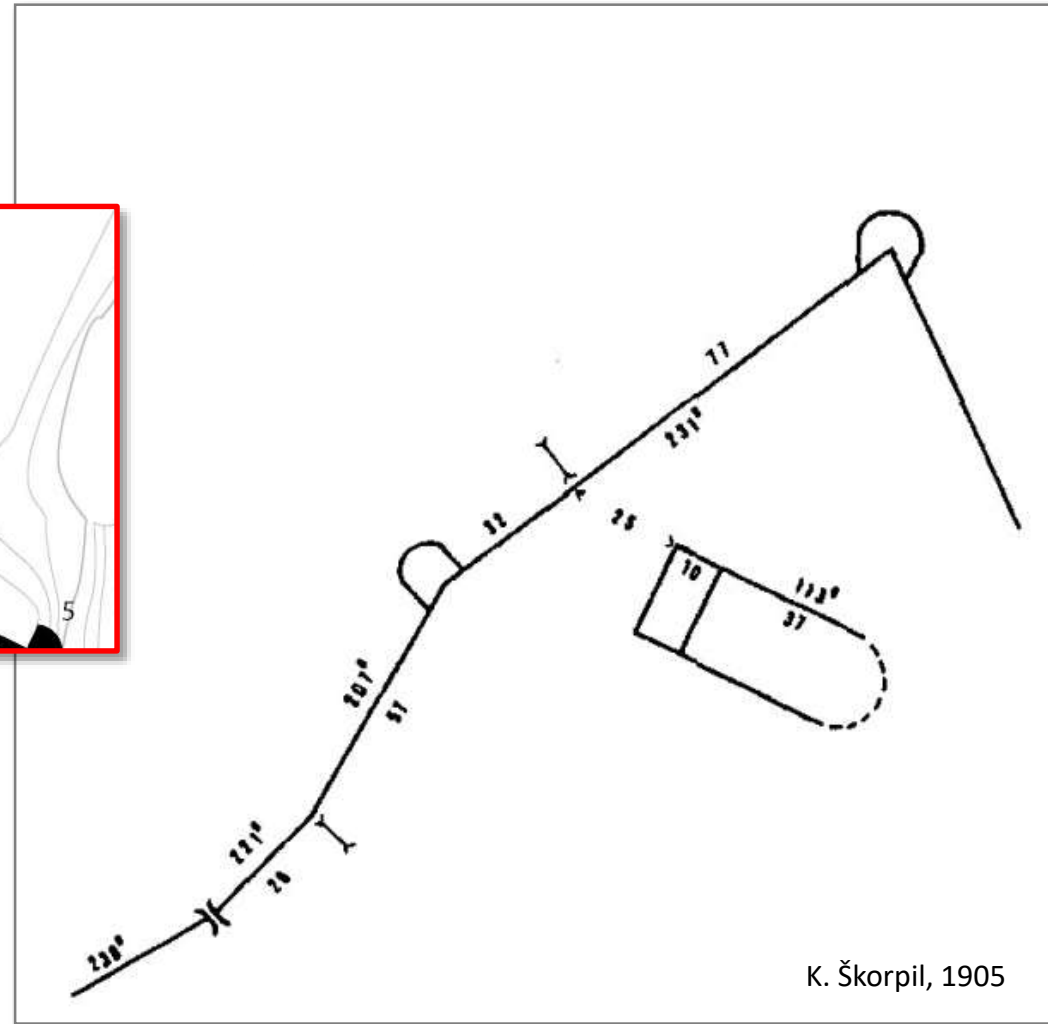
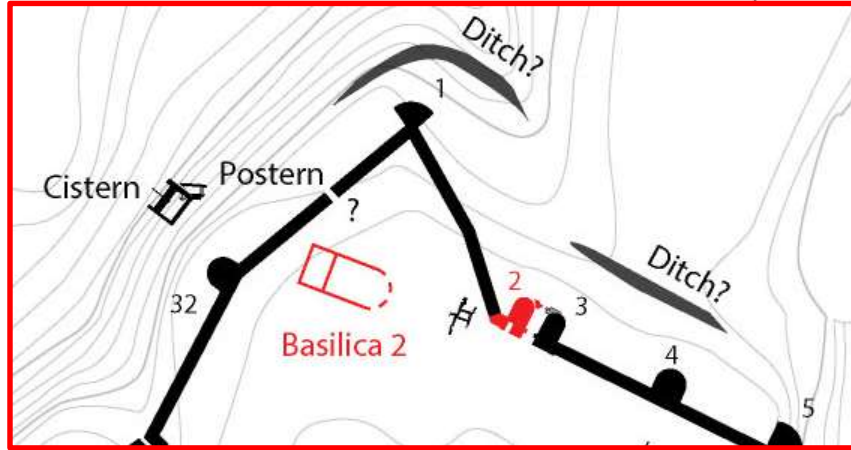


Sculpture from the crypt of the Christian Basilica № 3



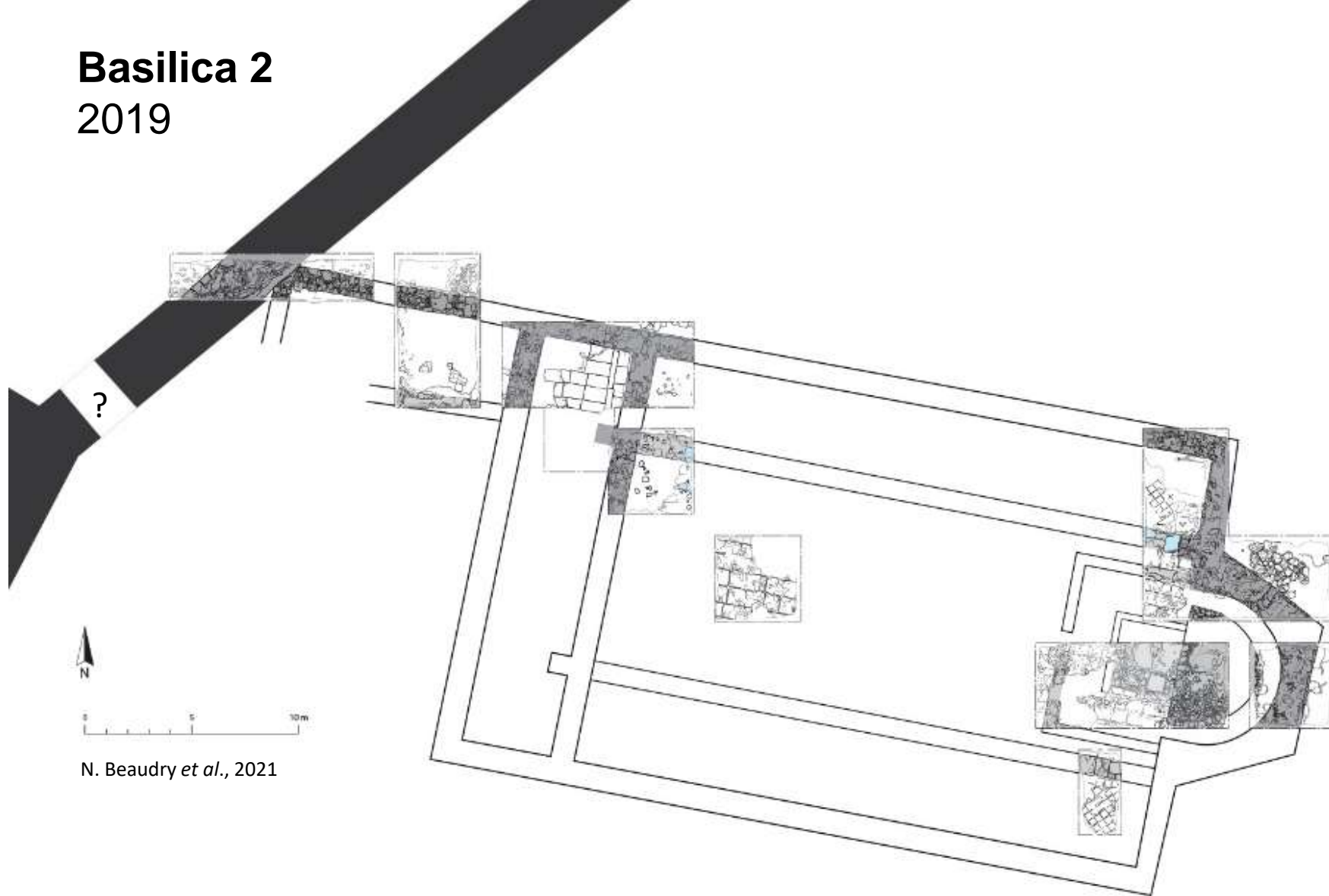
Reconstitution of the Chancel of Histria by Alexandru Suceveanu

Basilica 2



Basilica 2

2019



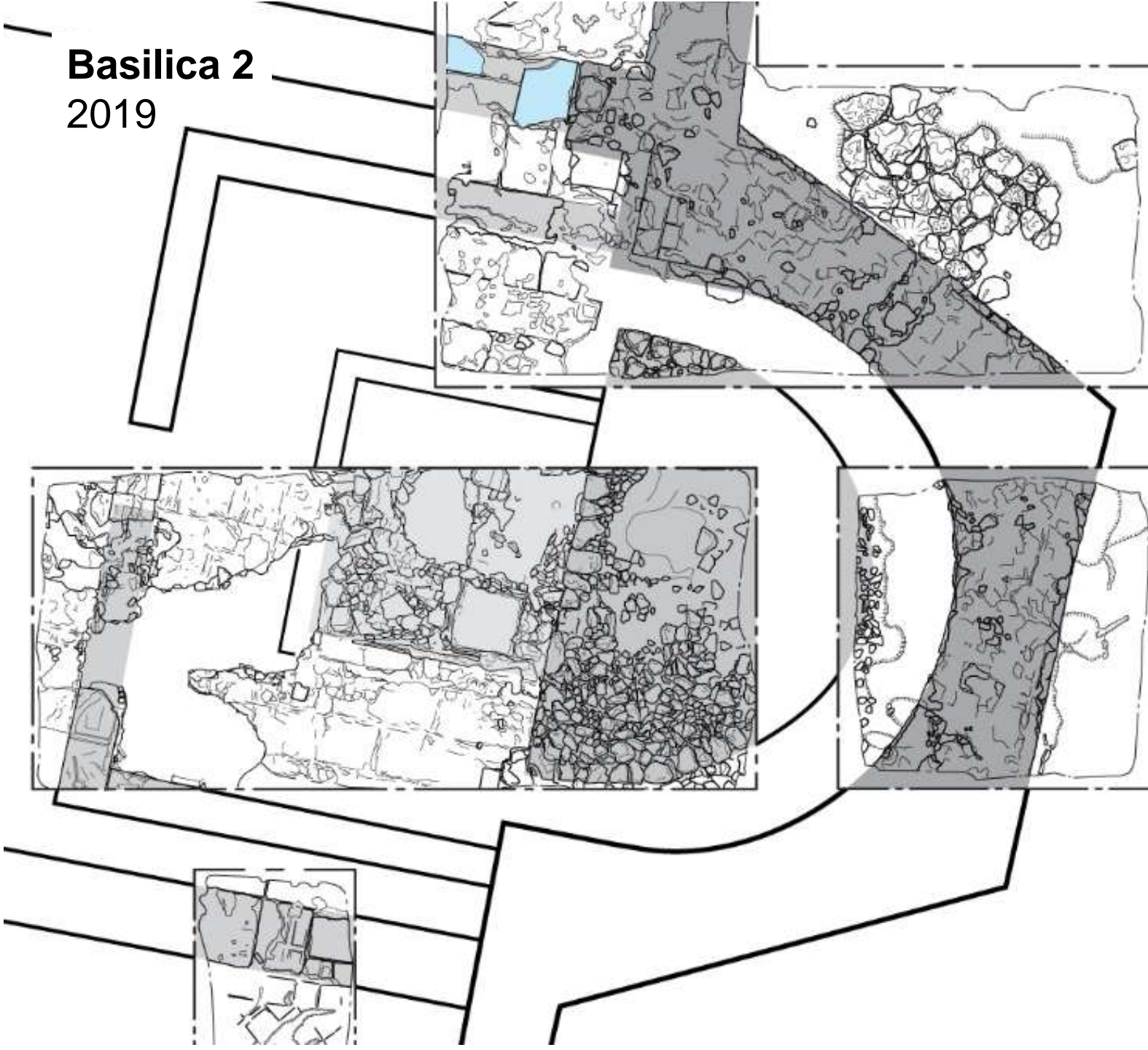
N. Beaudry *et al.*, 2021

Basilica 2
2019

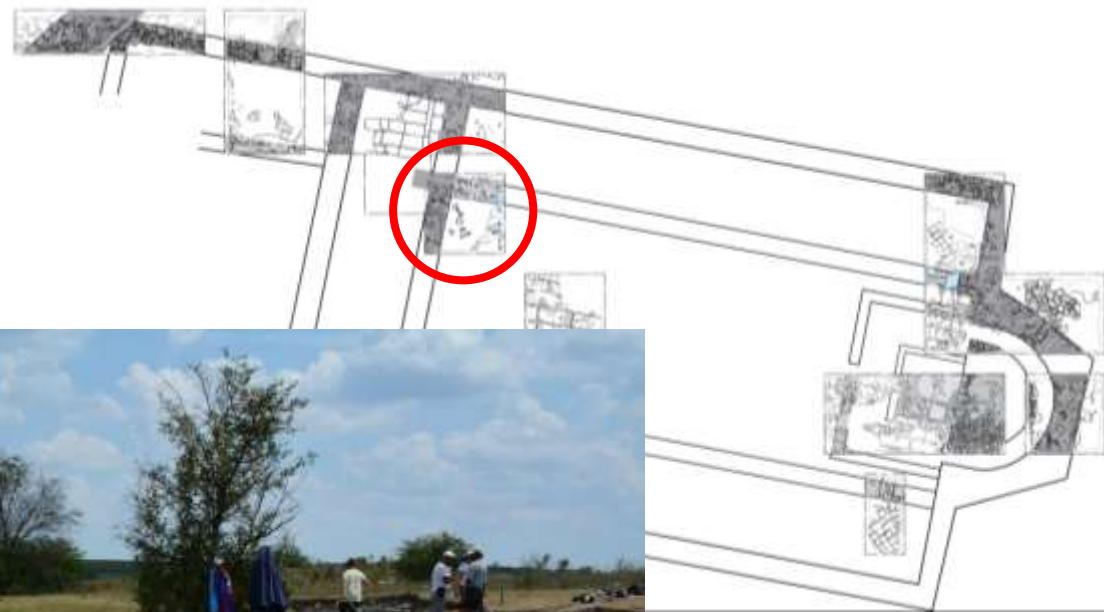


Basilica 2

2019

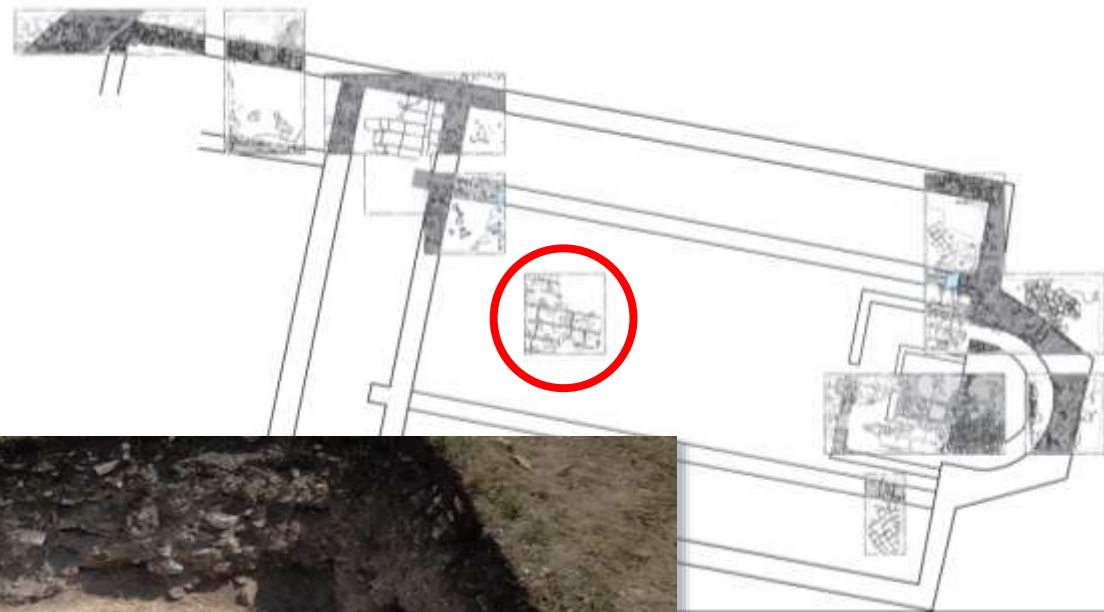


Basilica 2



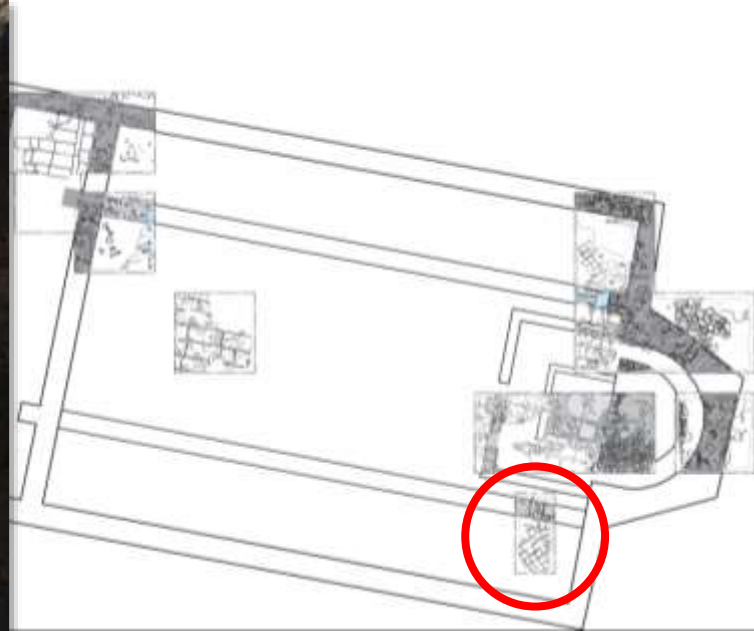
Remains of the paving of the nave and of the northern stylobate

Basilica 2



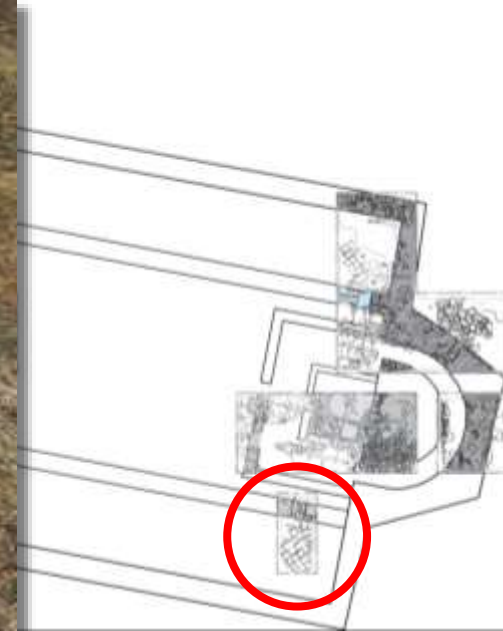
Impressions of marble slabs in the nave

Basilica 2



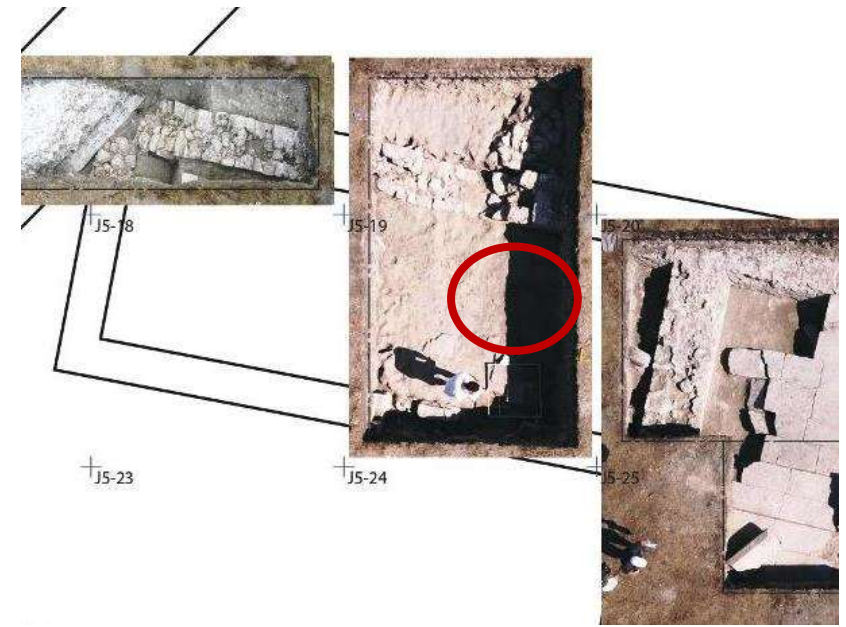
Impression of a marble slab of
the southern stylobate

Basilica 2



Impressions of a brick pavement in the southern aisle

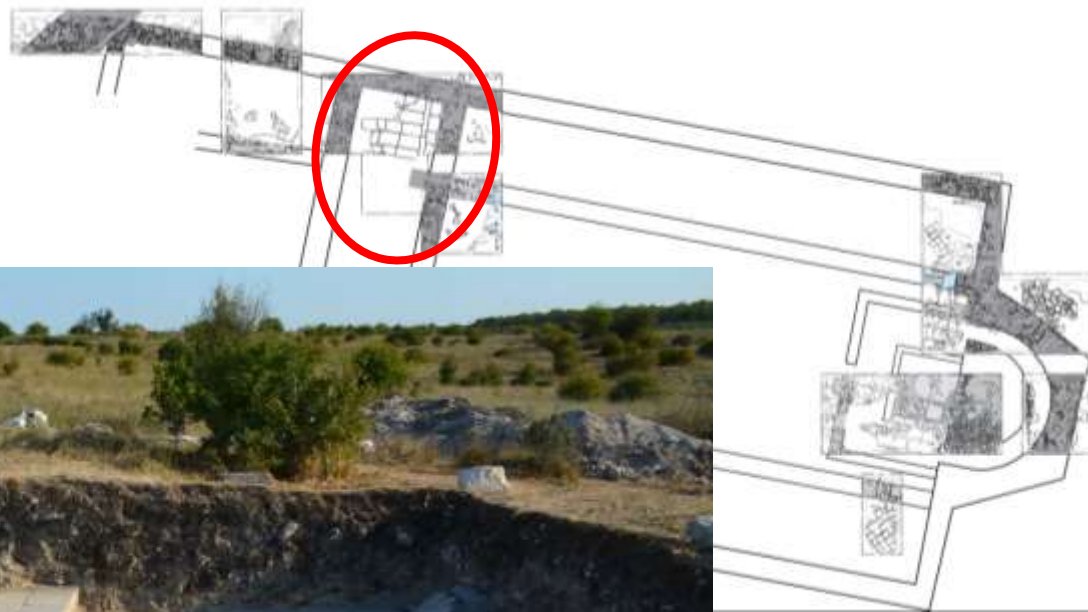
BASILICA 2



Brick pavement in the atrium

Basilica 2

Narthex



Limestone slabs and step in the narthex

Basilica 2
2022



Basilica 2



Marbres



Basilica 2

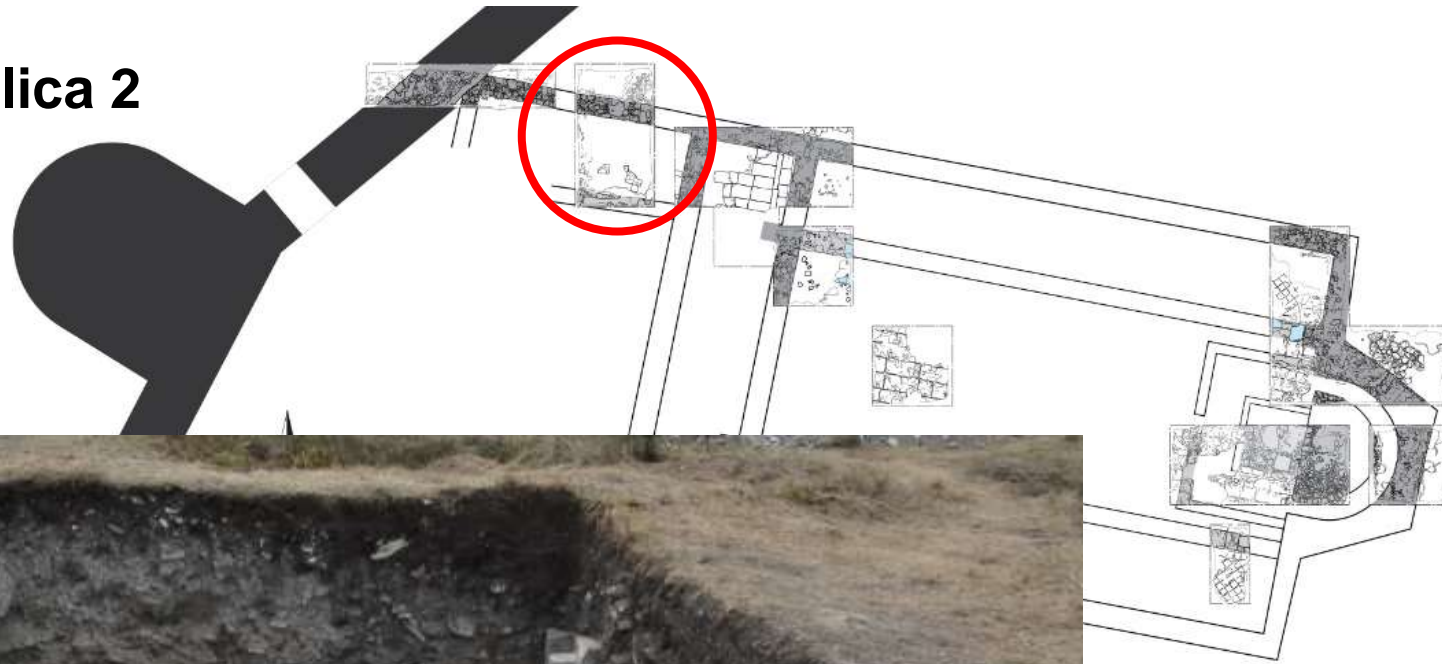


Basilica 2
2022



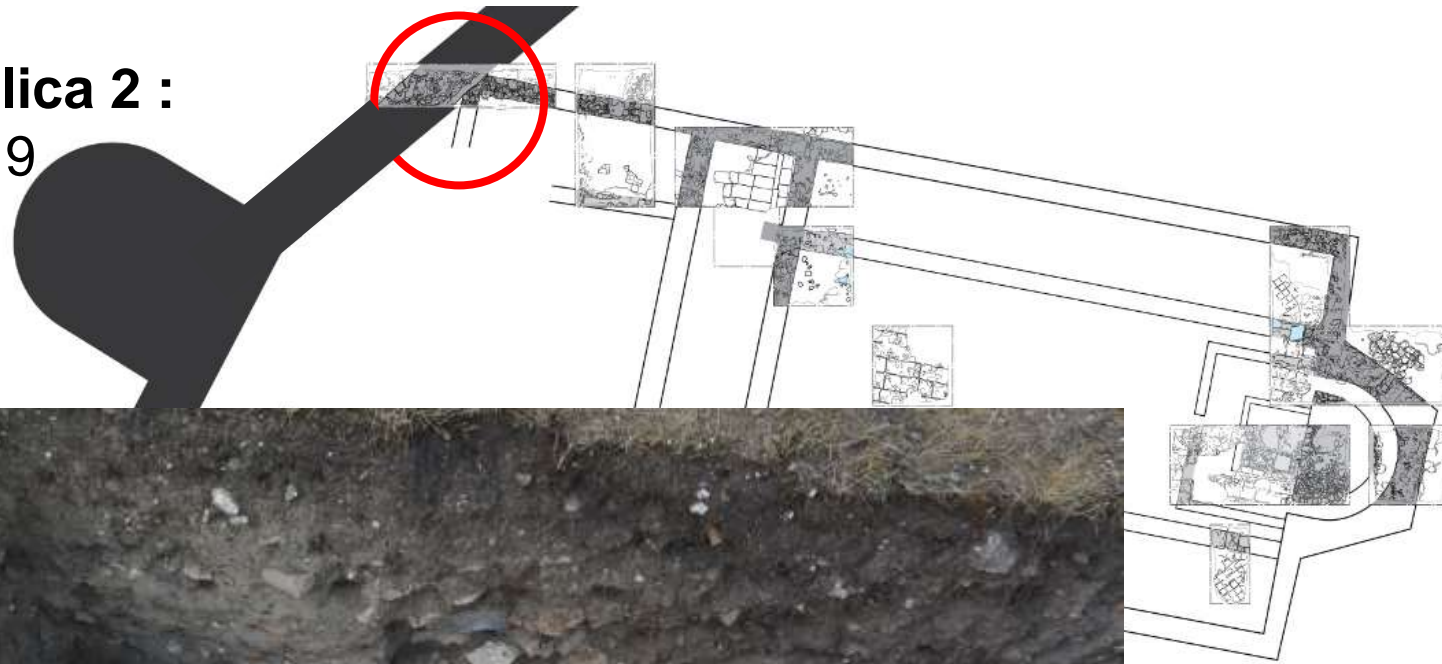
West of Basilica 2

Atrium, 2019



Possible atrium

West of Basilica 2 :
Rampart, 2019



Walls abutting
the rampart
west of
Basilica 2

West of Basilica 2 : the postern

2022

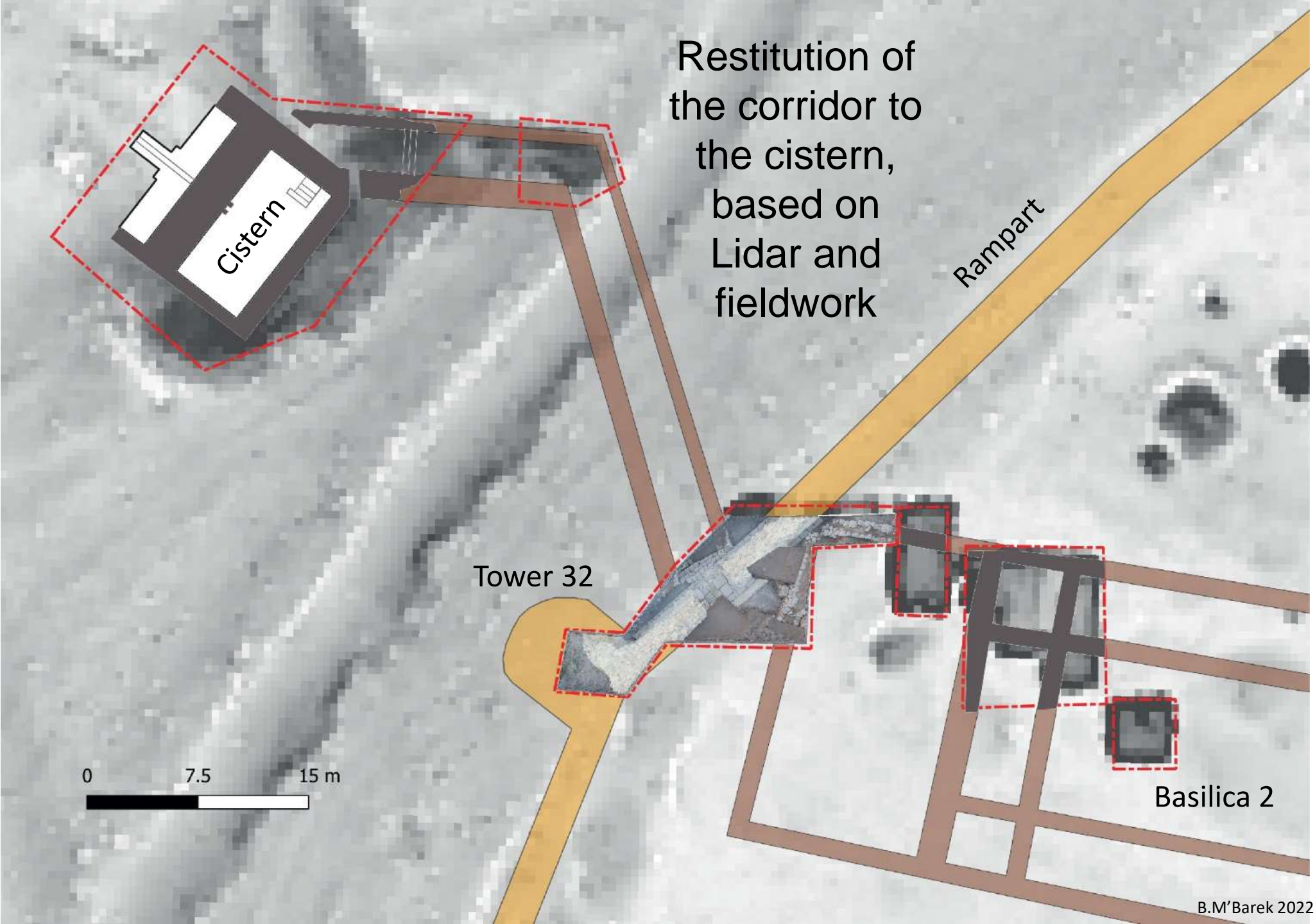


West of Basilica 2 : the postern 2022



The extramural cistern 2017





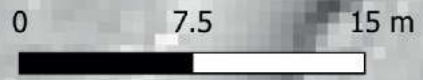
Restitution of the corridor to the cistern, based on Lidar and fieldwork

Rampart

Cistern

Tower 32

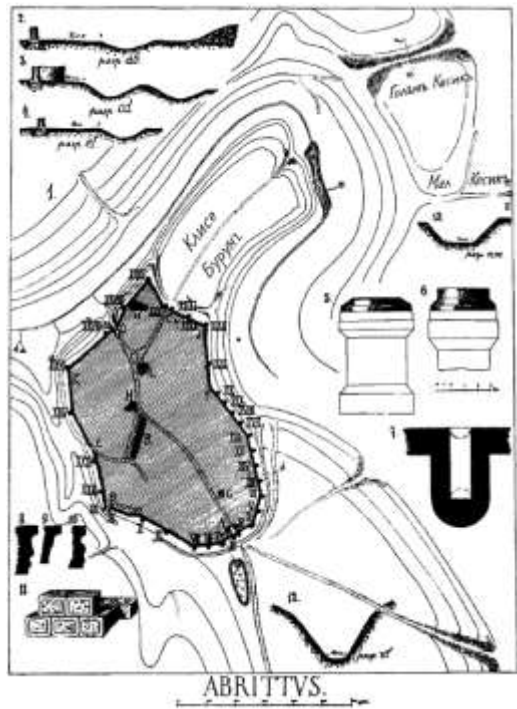
Basilica 2



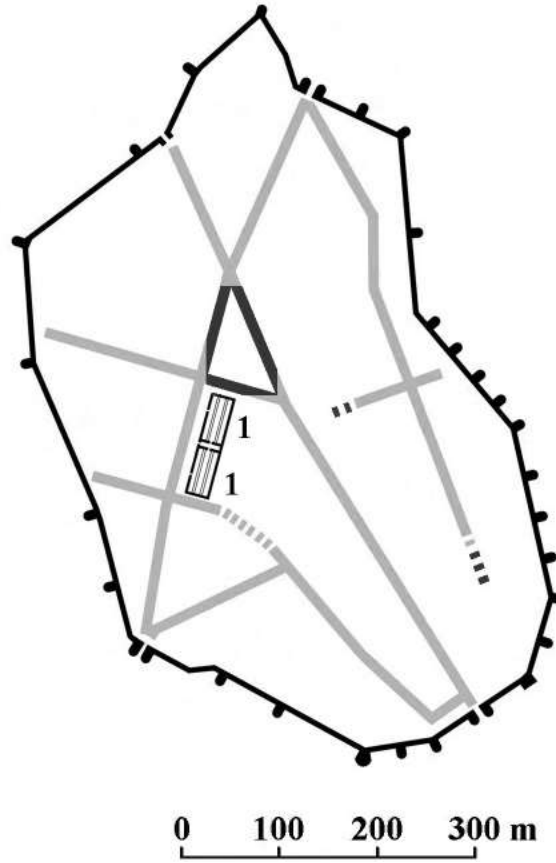


NEW METHODS – NEW DISCOVERIES – THE CASE OF THE SITE PLAN

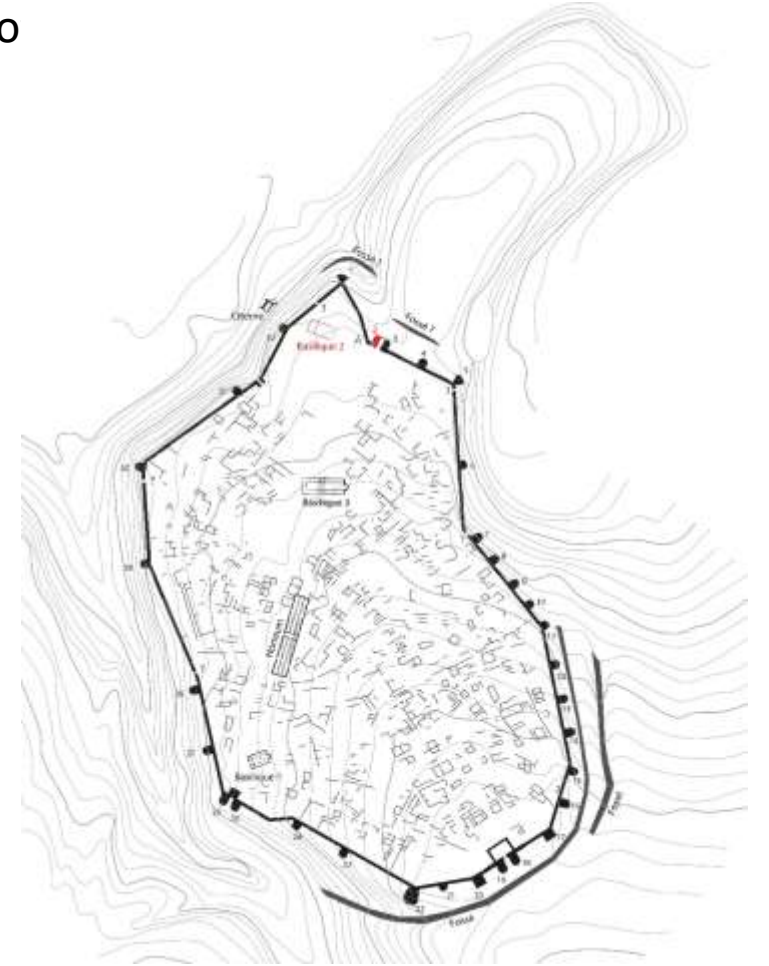
The integration of a range of remotely sensed aerial and satellite data, combining both newly acquired and historical archival material permitted to the international team to enrich significantly the plan o



Plan of Zaldapa according to Škorpi's publication

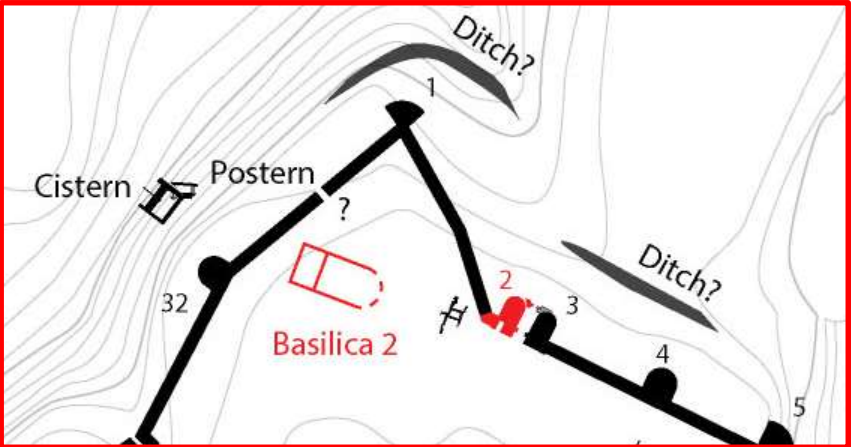


Plan of Zaldapa according to Torbatov (2000)

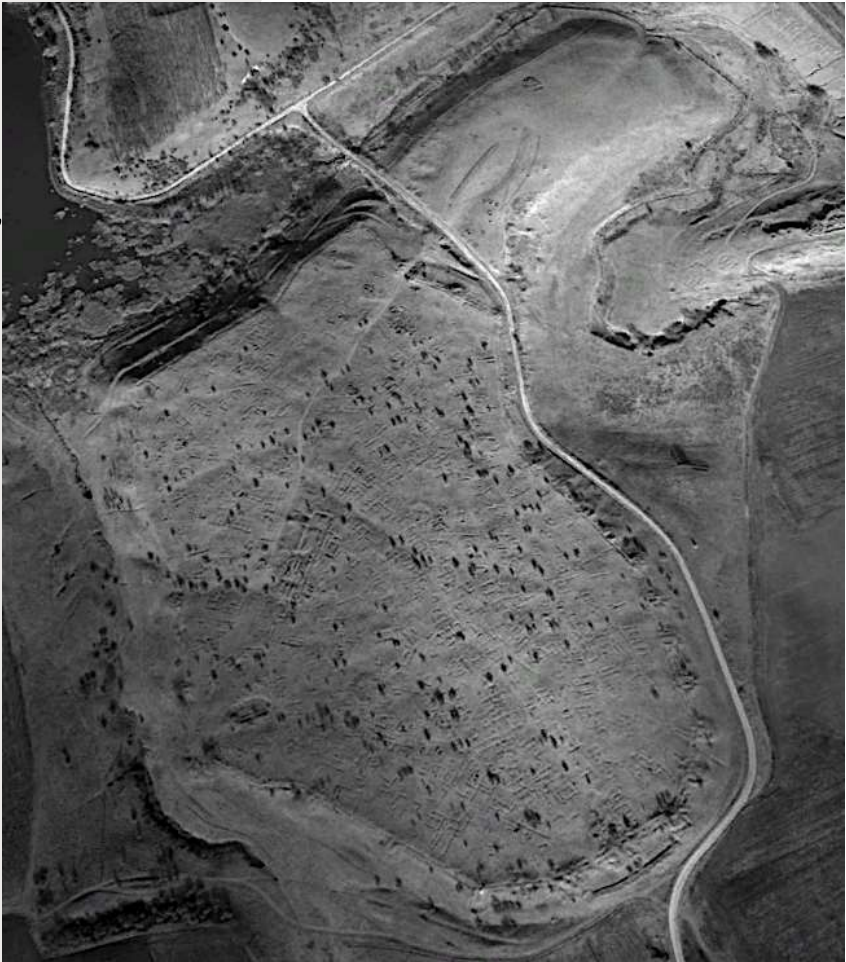


Plan of Zaldapa – international mission (adapted by B. M'Barek)

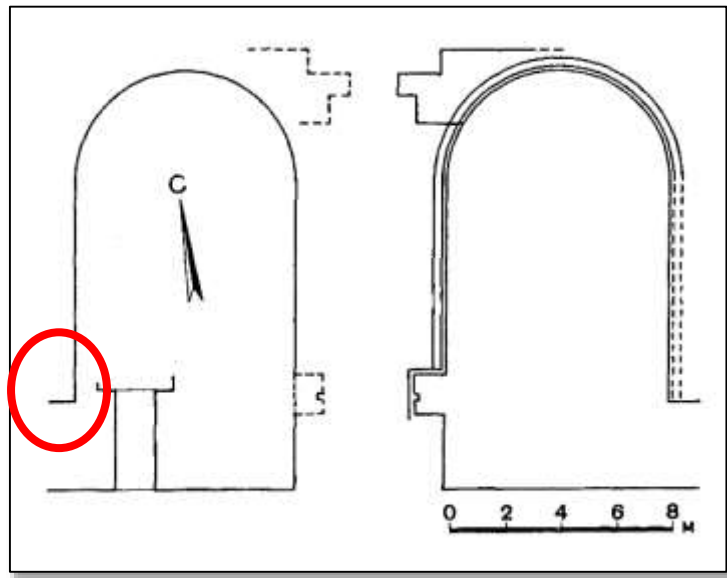
The northern sector 2017



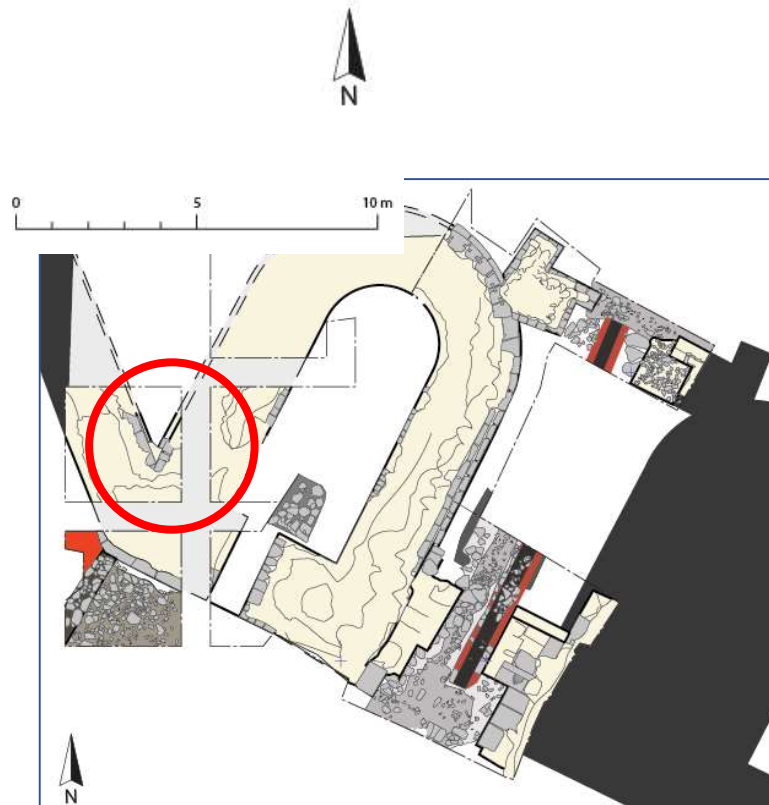
- Area selected to be excavated by the international mission – the northern sector where appear gaps on the urban fabric, including the NE main gate (1) and the nearby basilica (2).
- In 2021 and 2022 this zone was enlarged including the postern and the covered passage leading to the cistern down hill (3) and the tetraconch church (4) in South direction.



Northern Gate 2019



K. Škorpil, 1905



Adapted from B. M'Barek 2020

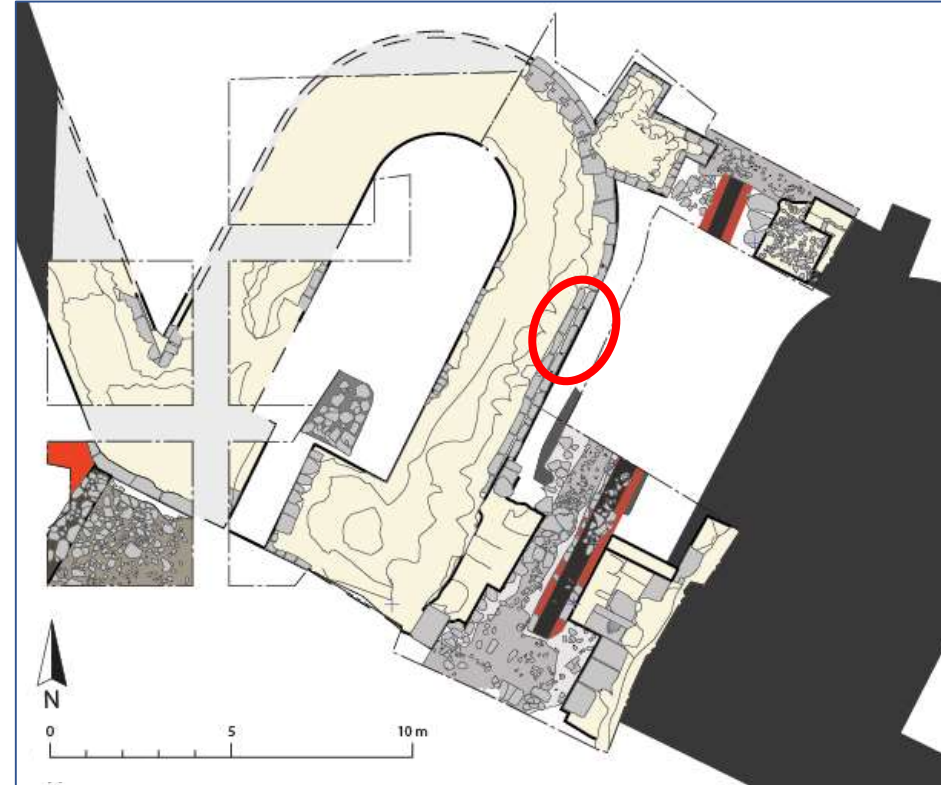


Junction of the rampart and Tower 2

Tower 2



Outer facing of Tower 2



Adapted from B. M'Barek 2020

The north gate

2nd phase

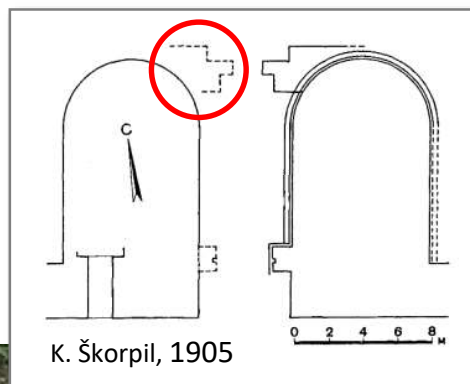


Repairs to the façade of Tower 2

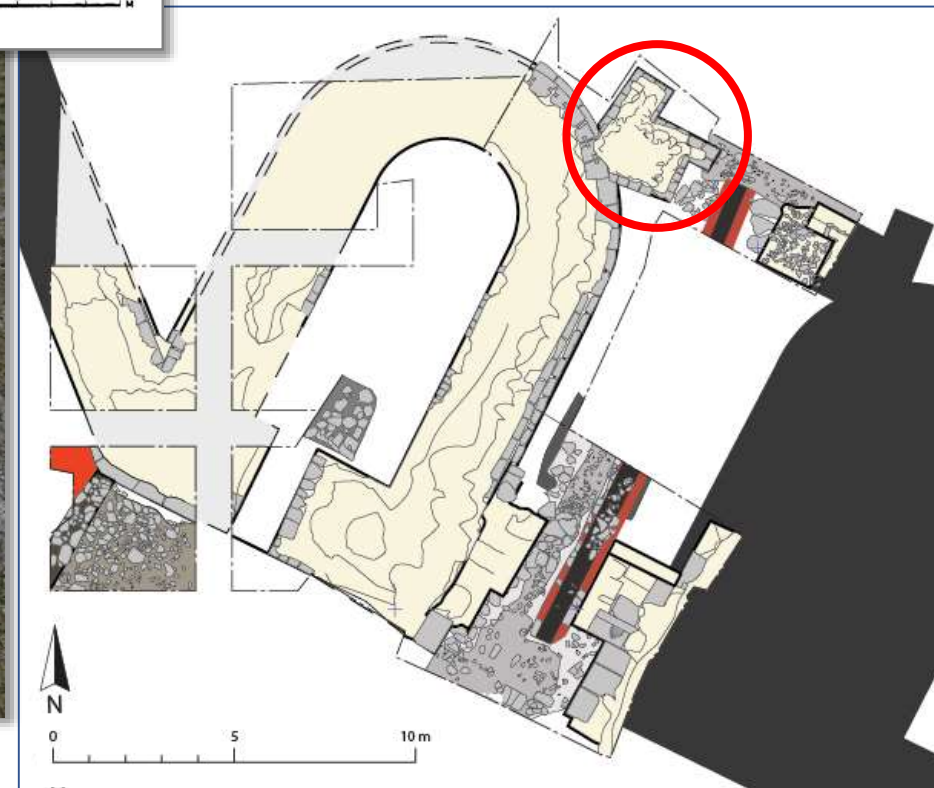


Adapted from B. M'Barek 2020

The north gate 3^d phase

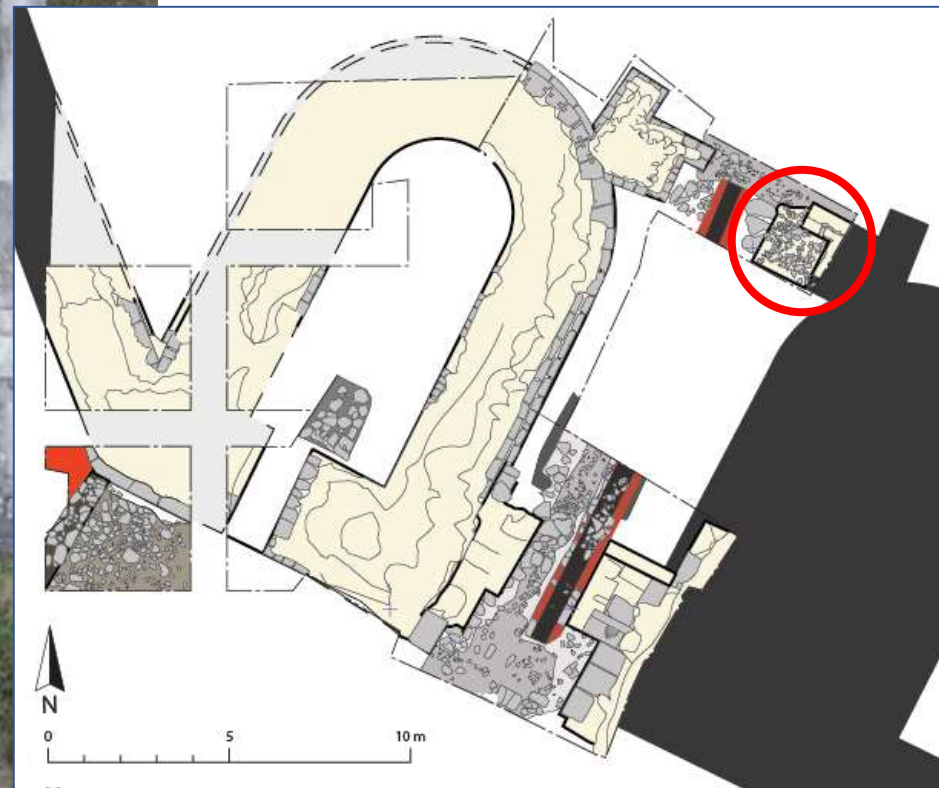


Wall abutting Tower 2



Adapted from B. M'Barek 2020

The north gate 4th phase



The north gate
2019

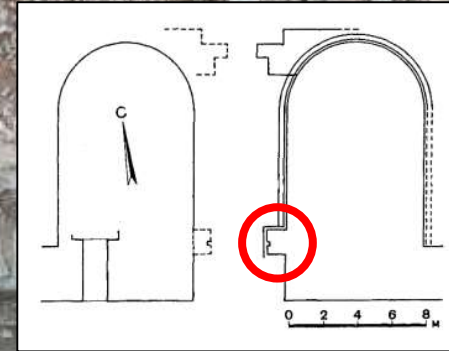


The north gate
2019



Remains of a
threshold

The north gate
2019



K. Škorpil, 1905

Harrow groove

Tower 2

2022



A bronze vessel
in a hearth



Tower 2
2022

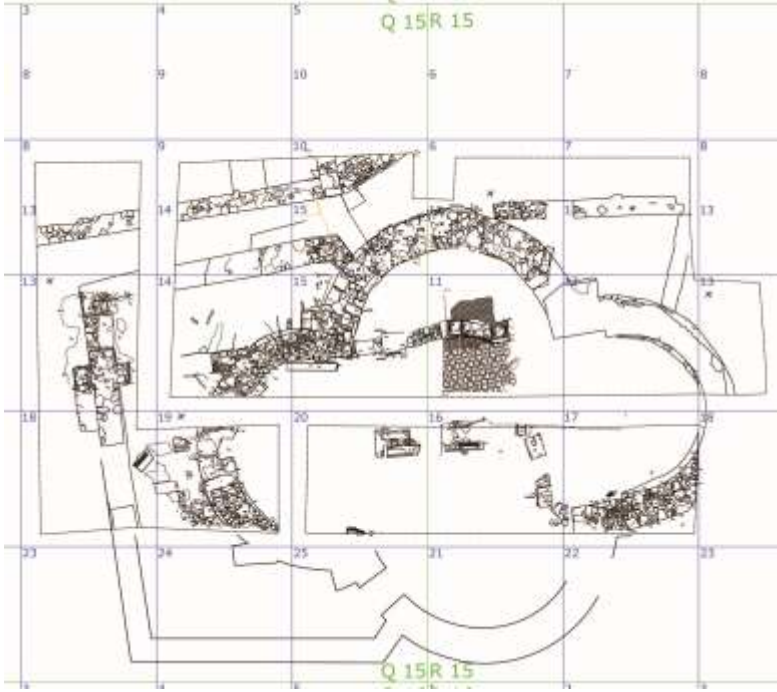
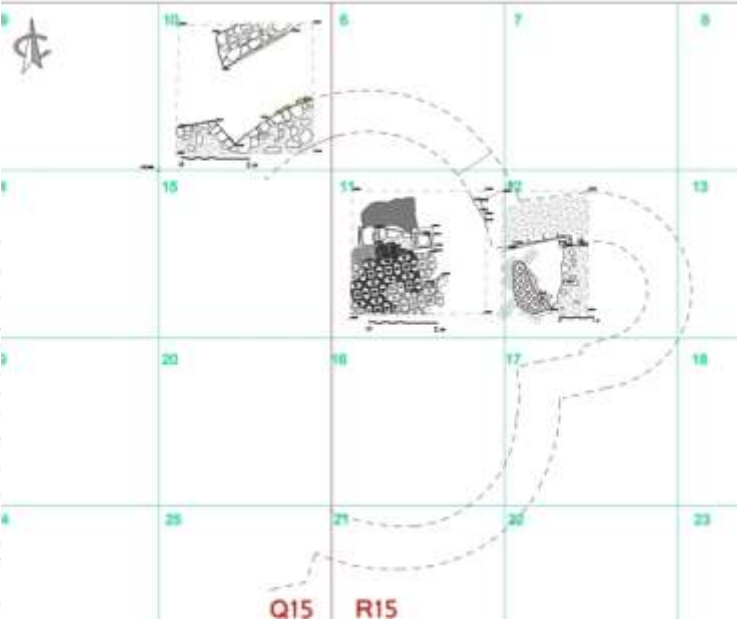


THE SIXTHE CHURCHE – THE TETRACONCH



0m 100m 500m

2019



2022







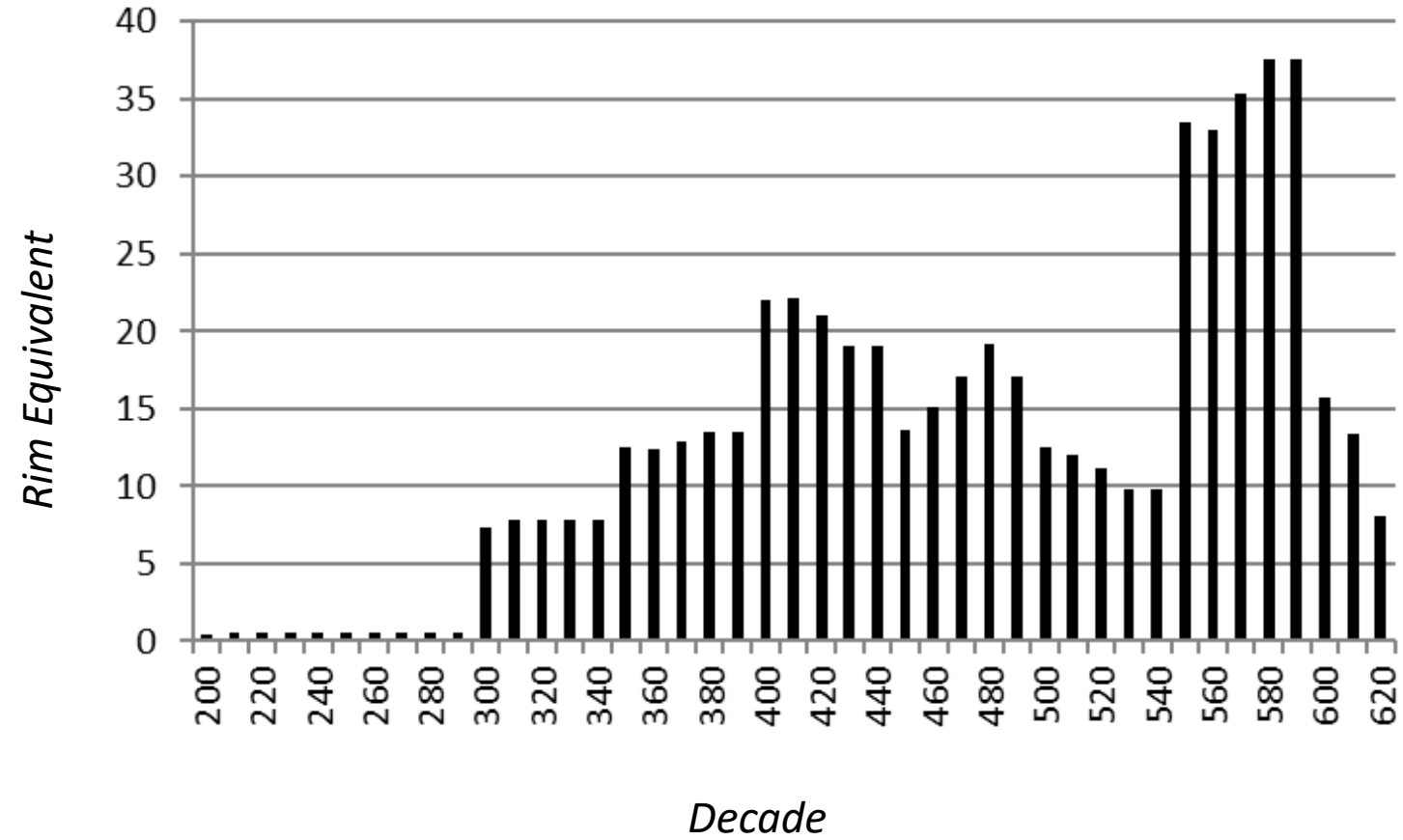
THE TETRACONCH 2019





Pottery

Preliminary results, 2018





Tetraconch

Basilicas 3-4

North gate

Basilica 2

Postern

Cistern

Implementation of a LiDAR (winter 2021) financed by the project Danubius directed by D. Moreau



Covered area



Planned area